

# COUNTY OF SAN MATEO

## Inter-Departmental Correspondence

Date: September 14, 2001

Board Meeting Date: September 25, 2001

**TO:** Honorable Board of Supervisors  
**FROM:** Neil R. Cullen, Director of Public Works  
**SUBJECT:** Slurry Sealing of Roads Previously Chip Sealed - Skyline/La Honda Area

### RECOMMENDATION

Determine if a slurry seal (a combination of an asphaltic emulsion and sand) should be applied to the roads that were previously chip sealed (a combination of asphalt emulsion and crushed stone) in the Skyline and La Honda areas in order to provide a smoother surface for pedestrians and bicyclists who use these roads.

### Staff Recommendation

If your Board determines that the roads should be slurry sealed, adopt a resolution authorizing the Director of Public Works to contract for the work using the informal bidding procedures as provided by the Public Contract Code.

### Previous Board Action

1. Adopted a project in 1988 that chip sealed the rock and dirt roads maintained by the County in the Skyline Area.
2. Adopted the most recent project that applied a chip seal to some of the roads that were previously chip sealed in 1988 and to two roads in the La Honda area.
3. Adopted an Ordinance amending the County Ordinance Code which increased the monetary limit for informal bidding procedures for construction contracts to \$100,000 as provided by the Public Contract Code.

### Key Facts

1. Chip sealing, and a combination of a chip seal followed by a slurry seal, are two methods used by cities and counties throughout California to maintain the wearing surface of the agencies' roads.
2. We have generally used chip seals in areas that are considered rural as defined by area plans or zoning adopted by your Board, including the Skyline and La Honda areas. Chip seals initially have a coarse surface which can "smooth out" over an extended period of time.

Honorable Board of Supervisors

**Subject: Slurry Sealing of Roads Previously Chip Sealed - Skyline/La Honda Area**

September 14, 2001

**Board Meeting Date: September 25, 2001**

Page 2

3. We have generally used chip seals in areas that are considered rural as defined by area plans or zoning adopted by your Board, including the Skyline and La Honda areas. Chip seals initially have a coarse surface which can "smooth out" over an extended period of time.
4. Supervisor Gordon's staff and we received complaints about the most recent chip seal application in the Skyline and La Honda areas, as while these areas are rural in nature, the roads are used by the areas' residents for walking and biking as well as for access to their properties.
5. A member of Supervisor Gordon's staff and the Director of Public Works met with residents in the Skyline Road/Big Tree area of Skyline to discuss the chip seal surface, and the consensus of opinions were that the residents desired a smoother road surface similar to what existed prior to the application of the chip seal.
6. We believe that a smoother surface can be attained by applying a slurry seal over the chip seal, and this combination of seals has been used successfully in more suburban areas of the County.

### Discussion

Your Board in the late 1980's directed that all rock or dirt roads maintained by the County receive some form of wearing surface in order to comply with the Bay Area Air Quality Management District's directive to reduce the dust that was created by traffic using these types of roads. We subsequently chipped sealed the rock or dirt roads to meet your Board's directive and have maintained these roads as surfaced streets since that time.

The Department of Public Works uses the Pavement Management System developed by the Metropolitan Transportation Commission (MTC) as well as input from our Maintenance Division to develop recommendations for projects to maintain the approximately 316 miles of roads that the County is responsible for. Projects range from full reconstruction, resurfacing with asphalt concrete, chip seals, slurry seals and the combination of chip and slurry seals when the amount of road patching indicates that the road's wearing surface needs some type of overall repair. We also take into consideration if the road has a designed structural section, the volume of traffic using the road and the location of the road (rural or urban area) when making recommendations to your Board.

We recently recommended and your Board approved the chip sealing of approximately 7.6 miles of roads in the Skyline/La Honda areas and the chip/slurry sealing of the 5.5 miles of Cloverdale Road in Pescadero. Our recommendations were based on the criteria as discussed above and the fact that these applications had been used in the past and did not result in negative comments from the area's residents.

However, as stated under Key Facts above, Supervisor Gordon's staff and we received complaints about the chip seals and we met with the residents who reiterated their complaints about the difficulty they have in walking and bicycling on the chip seal surface.

Honorable Board of Supervisors

**Subject: Slurry Sealing of Roads Previously Chip Sealed - Skyline/La Honda Area**

September 14, 2001

**Board Meeting Date: September 25, 2001**

Page 3

Alternatives were discussed and the consensus of opinion was that the residents understand our need to look for cost affective methods to maintain the approximate 316 mile of roads that we are responsible for; that slurry sealing a chip sealed road is a relatively inexpensive method that we have used in other areas, most recently on Cloverdale Road in the Pescadero area; and that a slurry seal is a way that can return the relative smoothness back to their roads that they desire. We also explained and the residents understand that they would need to stay off the slurry seal once it is applied for approximately 6 to 8 hours depending on the temperature, and that prematurely driving on the fresh slurry can result in the asphalt material being deposited on their vehicles, or that turning on the surface before it sets will leave permanent marks in the surface. The residents at the meeting agreed that the inconvenience was worth improving the road surface and have requested that your Board approve the slurry seal work, and that the work be done this October while the temperature is still appropriate for this type of application.

We are recommending that if your Board determines that a slurry seal be applied, that all the roads that were previously chip sealed be done, as we believe that while the residents in all areas did not voice objections, the same concerns that we heard most likely exist in the other areas where the roads were chip sealed.

#### **Fiscal Impact**

The estimated cost of slurry sealing the approximately 7.6 miles of roads is \$80,000 which is below the \$100,000 limit for informal bidding as provided by the Public Contract Code and County Ordinance. We have contacted four slurry sealing companies and they have indicated that they can be available in October to do this work and we will expedite the bidding process if your Board determines that the roads should be slurry sealed.

The work can be paid for from Road Funds budgeted for fiscal year 2001-02 and which are appropriated under "All Other Roads." There is no impact to the General Fund.

A form of resolution has been approved by County Counsel.

  
Neil R. Cullen  
Director of Public Works

NRC:sdd

F:\USERS\ADMIN\ESD\Skyline-La Honda\BoardSup\2001\Skyline Chip Slurry BS Report Sept 25

F:\Users\NEILC\2001\skylinechipslurrybsreportsep25

cc: Milt Mares, County Counsel  
Brian C. Lee, Division Manager, Programming and Engineering Services

Resolution No. \_\_\_\_\_

**Board of Supervisors, County of San Mateo, State of California**

\*\*\*\*\*

**Resolution Authorizing the Director of Public Works to  
Use the Informal Bidding Procedures as Provided by the  
Public Contract Code and County Ordinance to Contract for the Slurry  
Sealing of the Roads that were Previously Chip Sealed in 2001 in the  
Skyline Area and in La Honda**

---

**RESOLVED**, by the Board of Supervisors of the County of San Mateo, State of California, that

**WHEREAS**, this Board previously approved a contract to chip seal various roads in the Skyline and La Honda areas as shown on Exhibit "A" attached hereto; and

**WHEREAS**, Members of this Board and the Department of Public Works have received complaints about the most recent chip seal application in the Skyline and La Honda areas, as the residents are having difficulty walking and biking on the chip seal surface of these roads; and

**WHEREAS**, the Department of Public Works has in the past recommended the application of a slurry seal over a chip seal surface on other roads in the County's maintained road system that are used for similar activities as described by the residents in the Skyline area; and

**WHEREAS**, this Board has considered the concerns of the residents; and

**WHEREAS**, the Director of Public Works has estimated that the cost of doing said work is below the monetary limit as set by the Public Contract Code and County Ordinance for informal bidding; and

**WHEREAS**, the Director of Public Works has recommended, if this Board determines to have a slurry seal applied to the roads previously chip sealed, that the work be done through the informal bidding process as allowed by the Public Contract Code and County Ordinance; and

**WHEREAS**, this Board has reviewed and considered the recommendation of the Director of Public Works.

**NOW, THEREFORE, IT IS HEREBY DETERMINED AND ORDERED** that the Director of Public Works is hereby authorized:

a) to contract for the slurry sealing of the roads previously chip sealed in the Skyline/La Honda areas as shown on Exhibit "A" attached hereto, using the informal bidding procedures as provided by Section 22032 et. seq. of the State of California Public Contract Code and by County Ordinance; and

b) to finance said work from the Road Fund Budget for Fiscal Year 2001-02.

\*\*\*\*\*

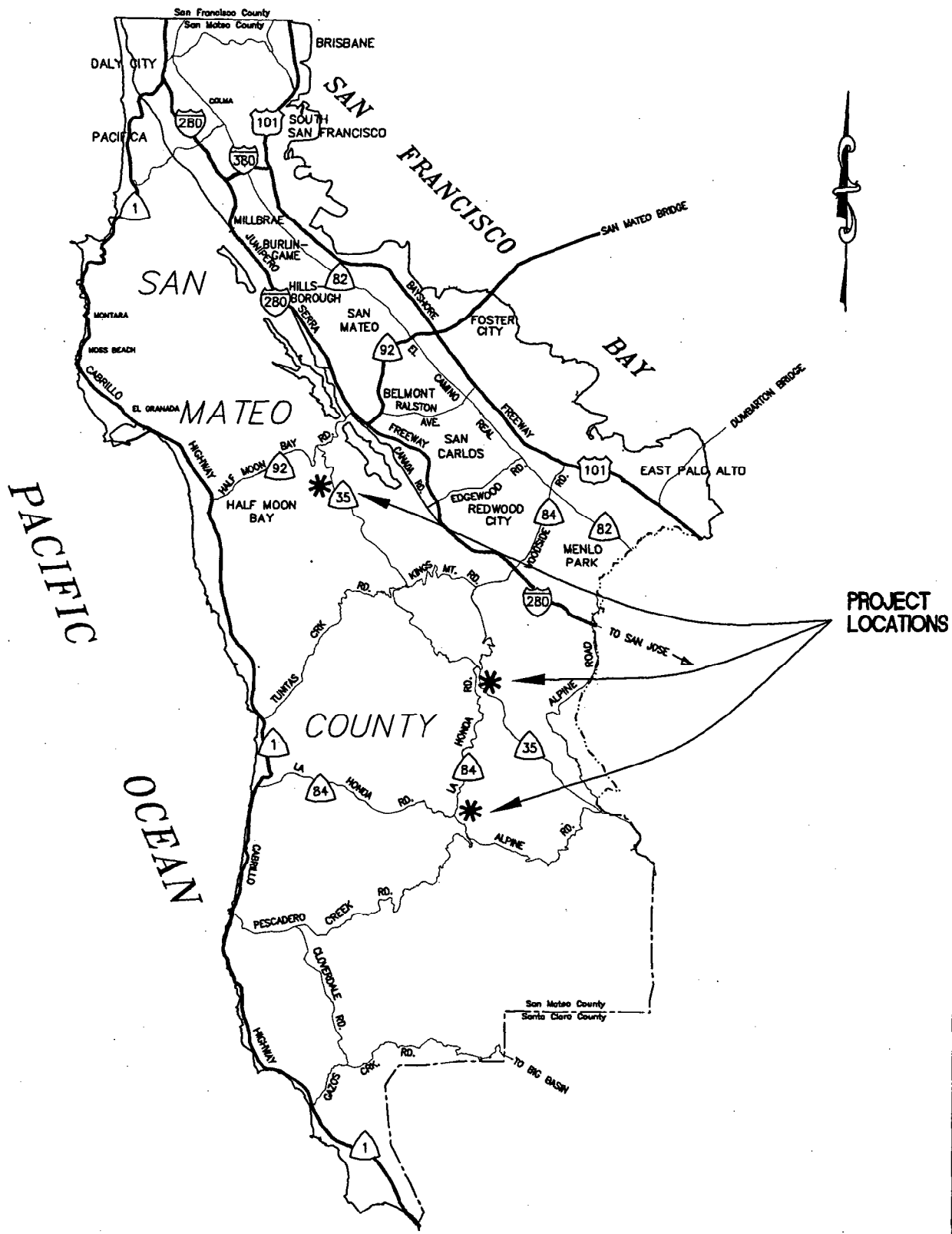

PROJECT LOCATIONS

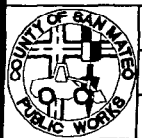

DESIGNED BY: RKL  
 CHECKED BY: RD  
 DRAWN BY: RKL

SLURRY SEALING OF VARIOUS  
 ROADS - COUNTY WIDE  
 VICINITY MAP

SCALE: AS SHOWN  
 DATE: 09/14/01  
 FILE NO: **S-4604**

NEIL R. CULLEN, DIRECTOR OF PUBLIC WORKS  
 SAN MATEO COUNTY

555 COUNTY CENTER, 5TH FLOOR  
 REDWOOD CITY, CALIFORNIA 94063-1665

EXHIBIT "A"

DWG. 1

FILENAME: F:\USERS\HAL\SDSK\PROJ\AE460-000\CHTYLDCMAP.DWG



INDICATES AREAS TO BE  
SLURRY SEALED

DESIGNED BY: RKL

CHECKED BY: RO

DRAWN BY: RKL

**THE SLURRY SEALING OF CUESTA REAL**  
- COUNTY WIDE -

**LOCATION MAP**

SCALE: NONE

DATE: 09/14/01

FILE NO. **S-4604**

NEIL R. CULLEN, DIRECTOR OF PUBLIC WORKS  
SAN MATEO COUNTY

555 COUNTY CENTER, 5TH FLOOR  
REDWOOD CITY, CALIFORNIA 94063-1665

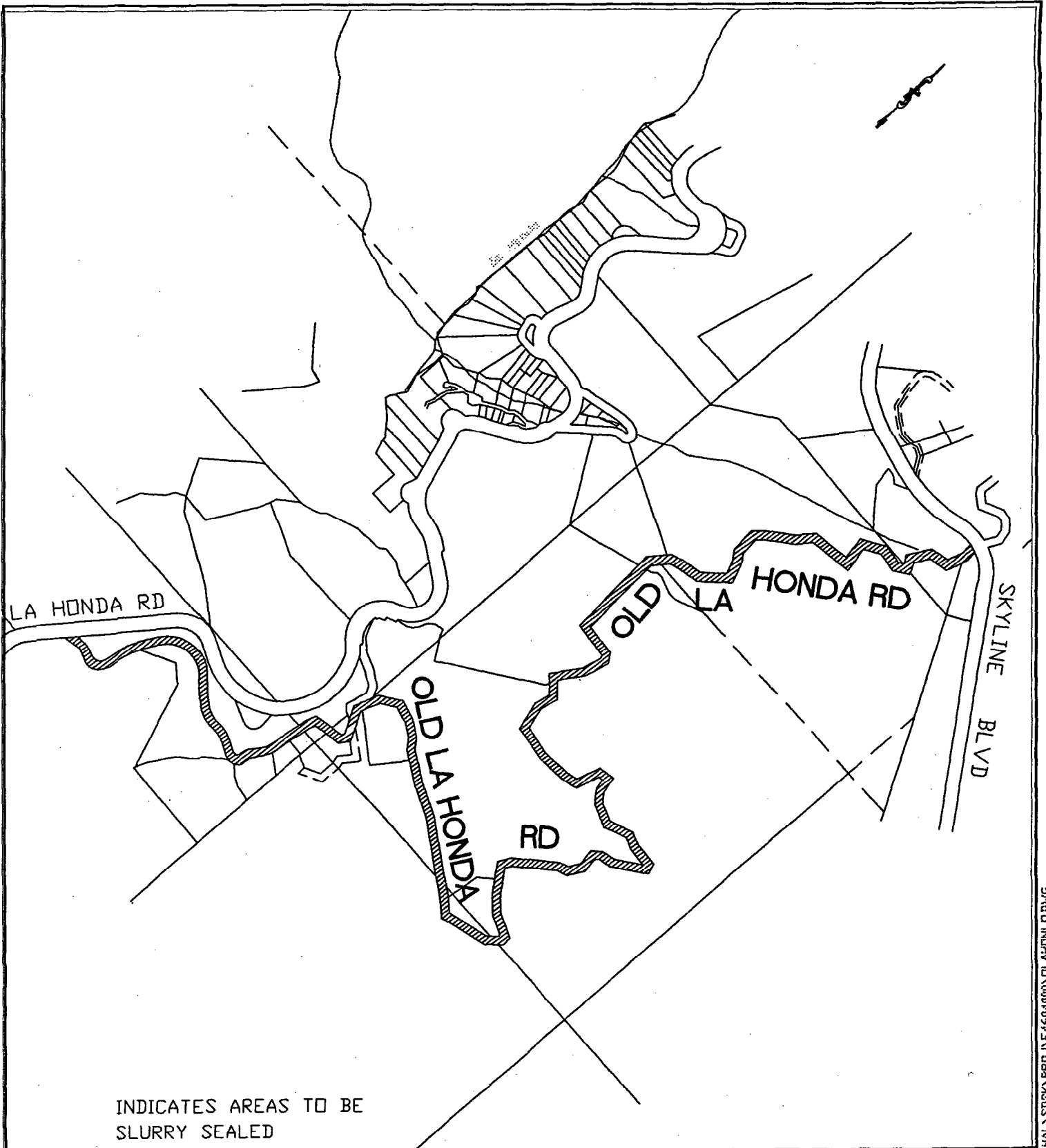

INDICATES AREAS TO BE  
SLURRY SEALED

DESIGNED BY: RKL	<b>THE SLURRY SEALING OF OLD LA HONDA ROAD - COUNTY WIDE</b>  <b>LOCATION MAP</b>	SCALE: NONE
CHECKED BY: RO		DATE: 09/14/01
DRAWN BY: RKL		FILE NO. <b>S-4604</b>
NEIL R. CULLEN, DIRECTOR OF PUBLIC WORKS SAN MATEO COUNTY		555 COUNTY CENTER, 5TH FLOOR REDWOOD CITY, CALIFORNIA 94063-1665



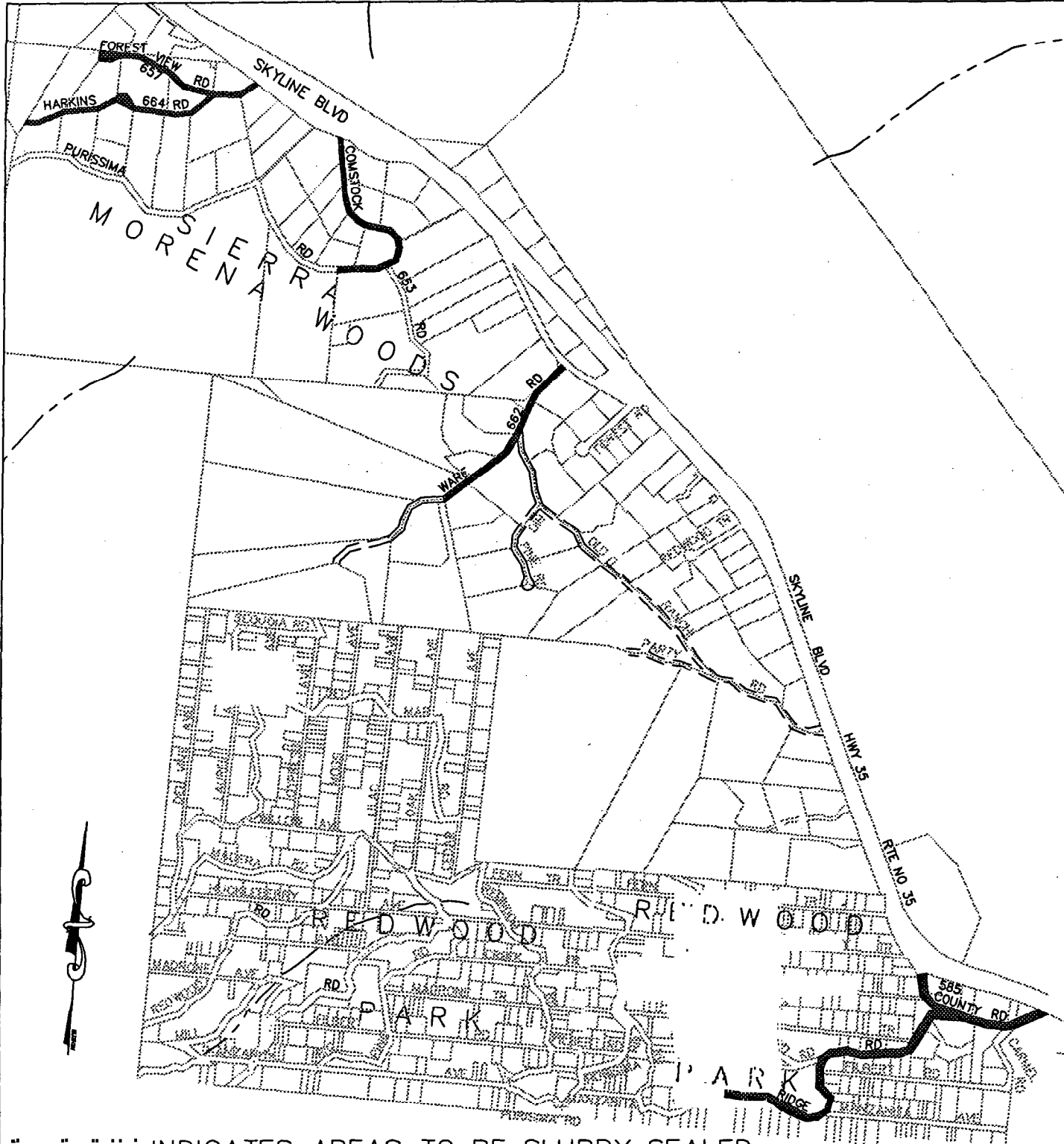

.. "....." INDICATES AREAS TO BE SLURRY SEALED

DESIGNED BY: RL	THE SLURRY SEALING OF VARIOUS ROADS – COUNTY WIDE <b>LOCATION MAP</b>	SCALE: NONE
CHECKED BY: RD		DATE: 03/23/01
DRAWN BY: RKL		FILE NO. <b>S-4604</b>
NEIL R. CULLEN, DIRECTOR OF PUBLIC WORKS SAN MATEO COUNTY		555 COUNTY CENTER, FIFTH FLOOR REDWOOD CITY, CALIFORNIA 94063-1662

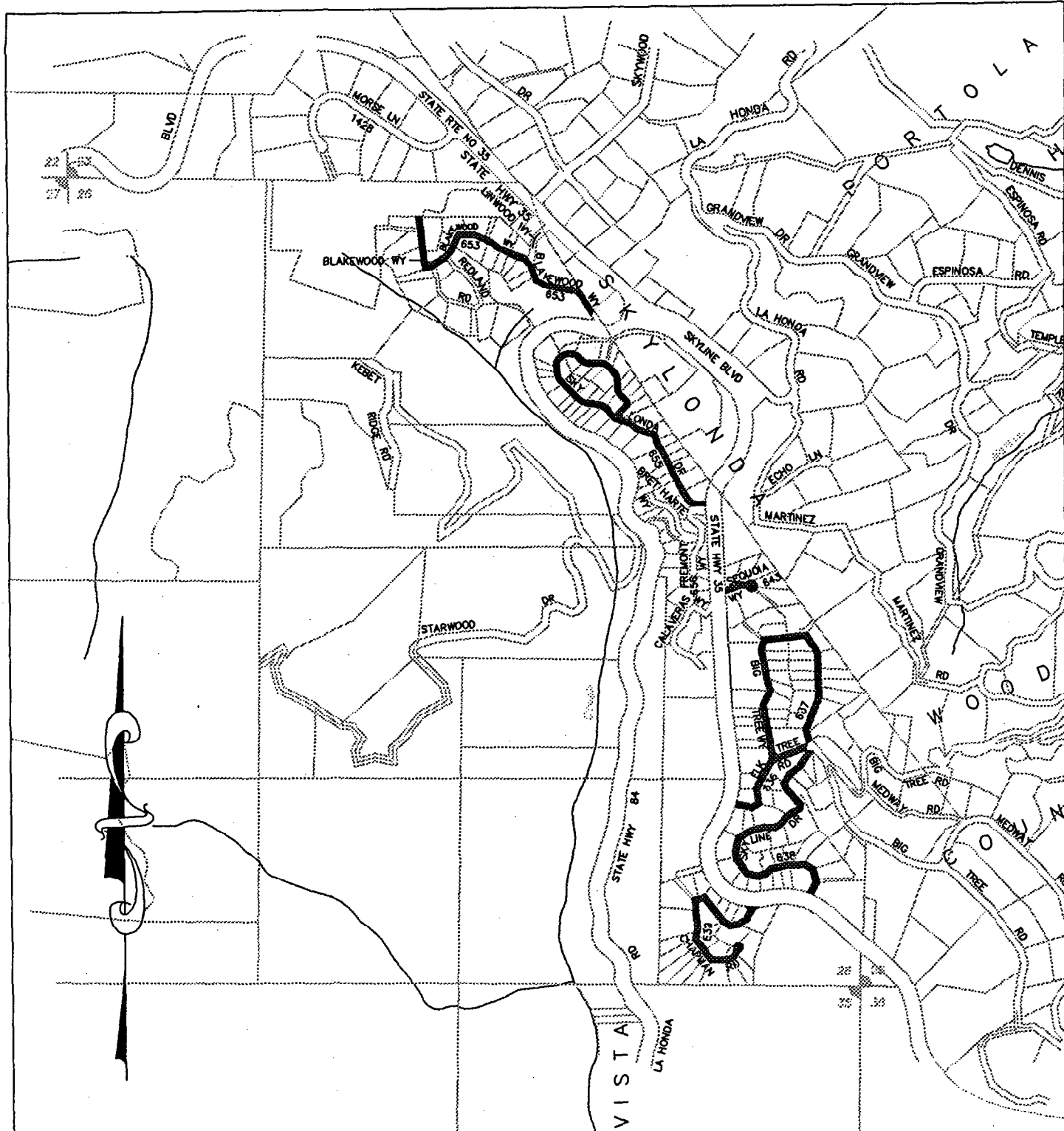

INDICATES AREAS TO BE SLURRY SEALED

DESIGNED BY: RL  
 CHECKED BY: RD  
 DRAWN BY: AGG

THE SLURRY SEALING OF VARIOUS  
 ROADS - COUNTY WIDE

**LOCATION MAP**

SCALE: NONE  
 DATE: 09/14/01  
 FILE NO. **S-4604**

NEIL R. CULLEN, DIRECTOR OF PUBLIC WORKS  
 SAN MATEO COUNTY

555 COUNTY CENTER, FIFTH FLOOR  
 REDWOOD CITY, CALIFORNIA 94063-1662

30Mar01 8:14am Drawing Filename: F:\USERS\HAL\SDSK\PROJ\4804000\LOC\_REDPAREA.DWG

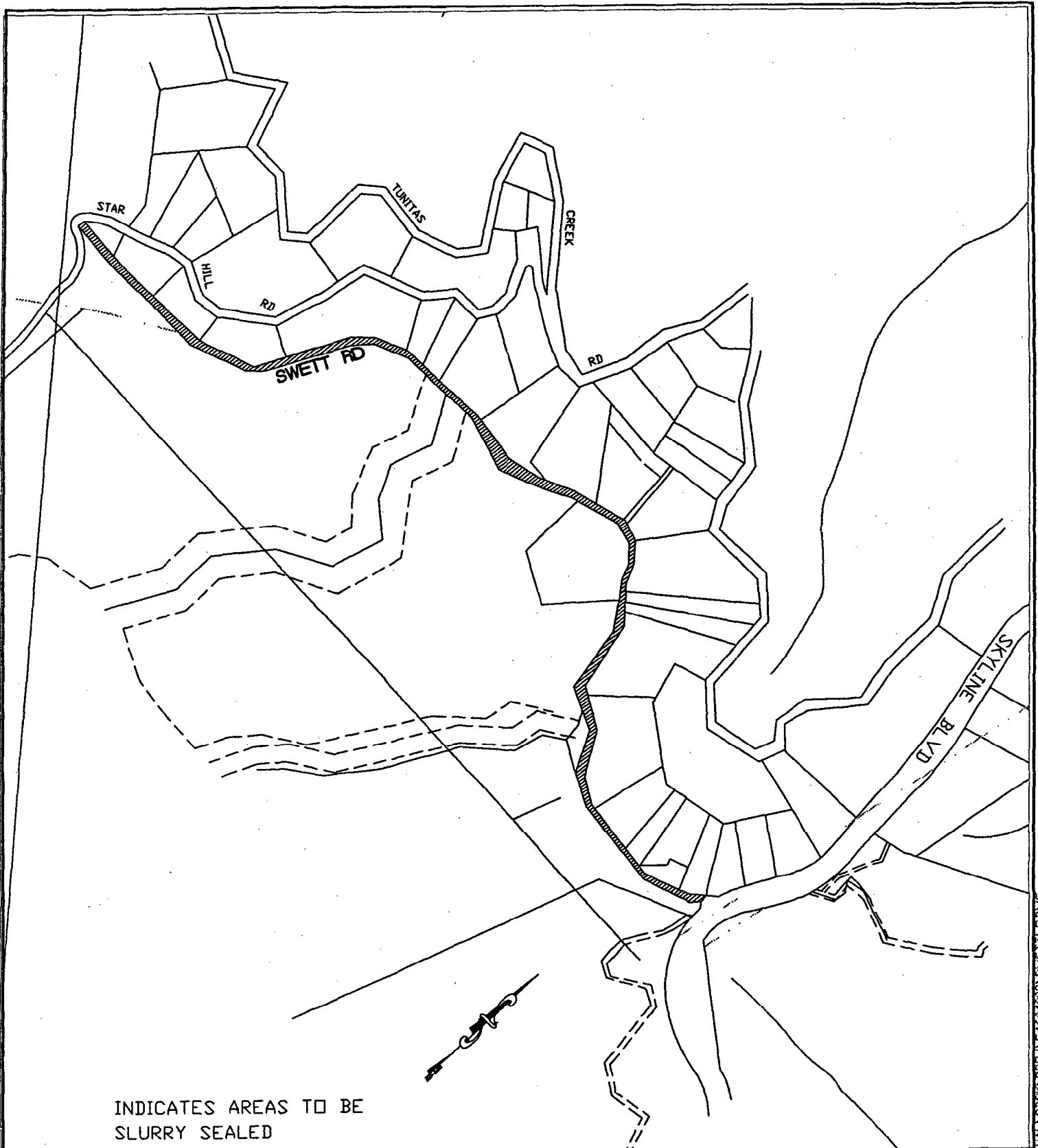

INDICATES AREAS TO BE  
SLURRY SEALED

DESIGNED BY: RKL	<b>THE SLURRY SEALING OF SWETT ROAD</b> - COUNTY WIDE - <b>LOCATION MAP</b>	SCALE: NONE
CHECKED BY: RO		DATE: 09/14/01
DRAWN BY: RKL		FILE NO. <b>S-4604</b>
NEIL R. CULLEN, DIRECTOR OF PUBLIC WORKS SAN MATEO COUNTY		555 COUNTY CENTER, 5TH FLOOR REDWOOD CITY, CALIFORNIA 94063-1665