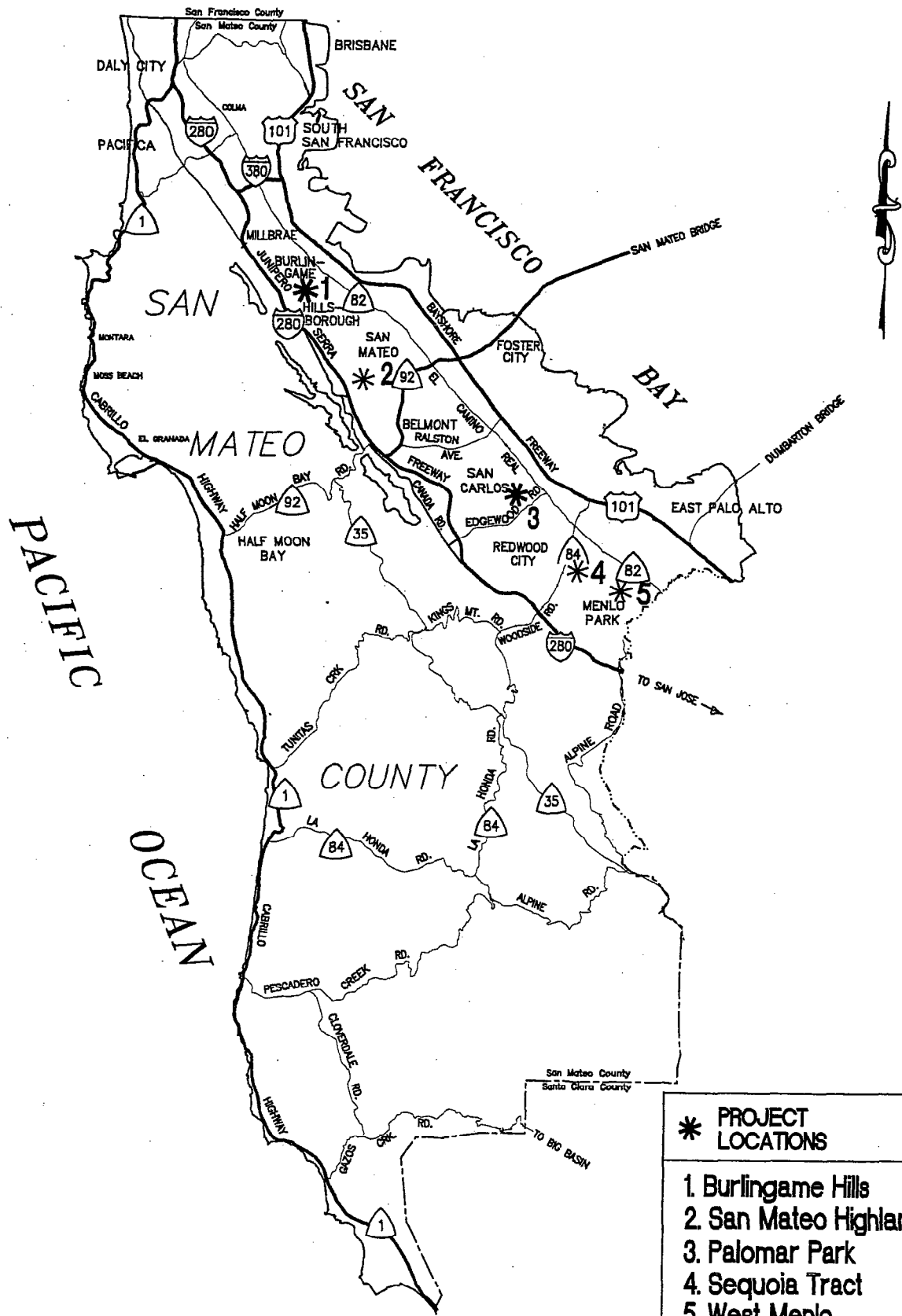

Exhibit "A"



- \* PROJECT LOCATIONS**
1. Burlingame Hills
  2. San Mateo Highlands
  3. Palomar Park
  4. Sequoia Tract
  5. West Menlo



DESIGNED BY: GT  
 CHECKED BY: AMS  
 DRAWN BY: GT

**BAYSIDE SLURRY SEAL PROJECT**  
**SAN MATEO COUNTY, CA.**  
**VICINITY MAP**

SCALE: AS SHOWN  
 DATE: 12/10/2001  
 FILE NO: S/4648

NEIL R. CULLEN, DIRECTOR OF PUBLIC WORKS  
 SAN MATEO COUNTY

555 COUNTY CENTER, 5TH FLOOR  
 REDWOOD CITY, CALIFORNIA 94063-1665

FILENAME: FUSERS DESIGN.DWG \E:4648000.DWG Location.DWG

Exhibit "A"

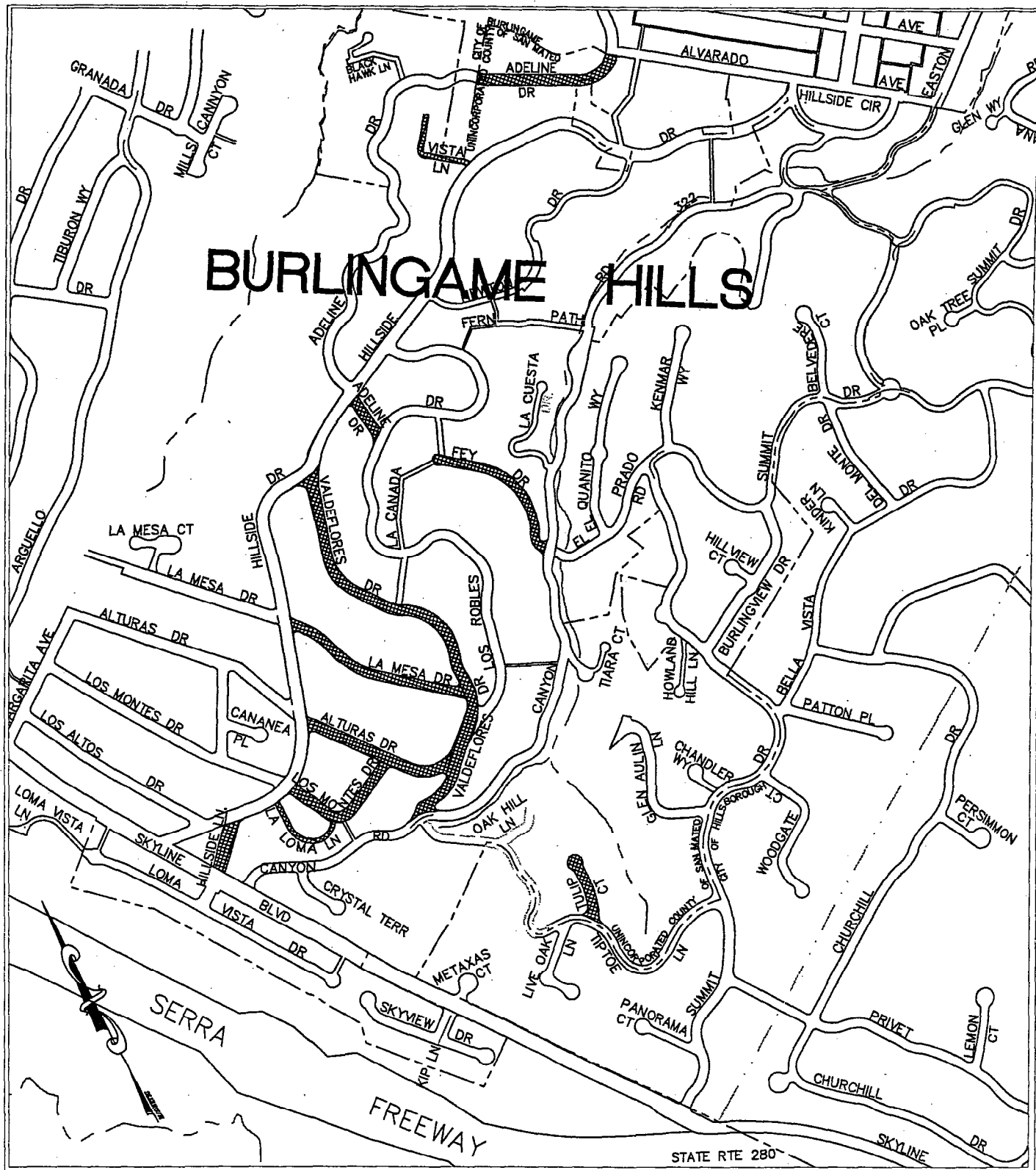

# BURLINGAME HILLS



INDICATES AREAS TO BE SLURRY SEALED



DESIGNED BY: GT  
 CHECKED BY: AMS  
 DRAWN BY: GT

BAYSIDE SLURRY SEAL  
 ROAD IMPROVEMENTS PROJECT  
**PROJECT LOCATION 1 (1/1)**

SCALE: NONE  
 DATE: 12/10/2001  
 FILE NO: **S/4648**

NEIL R. CULLEN, DIRECTOR OF PUBLIC WORKS  
 SAN MATEO COUNTY

555 COUNTY CENTER, 5TH FLOOR  
 REDWOOD CITY, CALIFORNIA 94063-1665

10Dec01 1:24pm Drawing Filename: F:\USERS\DESIGN\LD\1E4648000\DWG\EXH4.DWG

Exhibit "A"

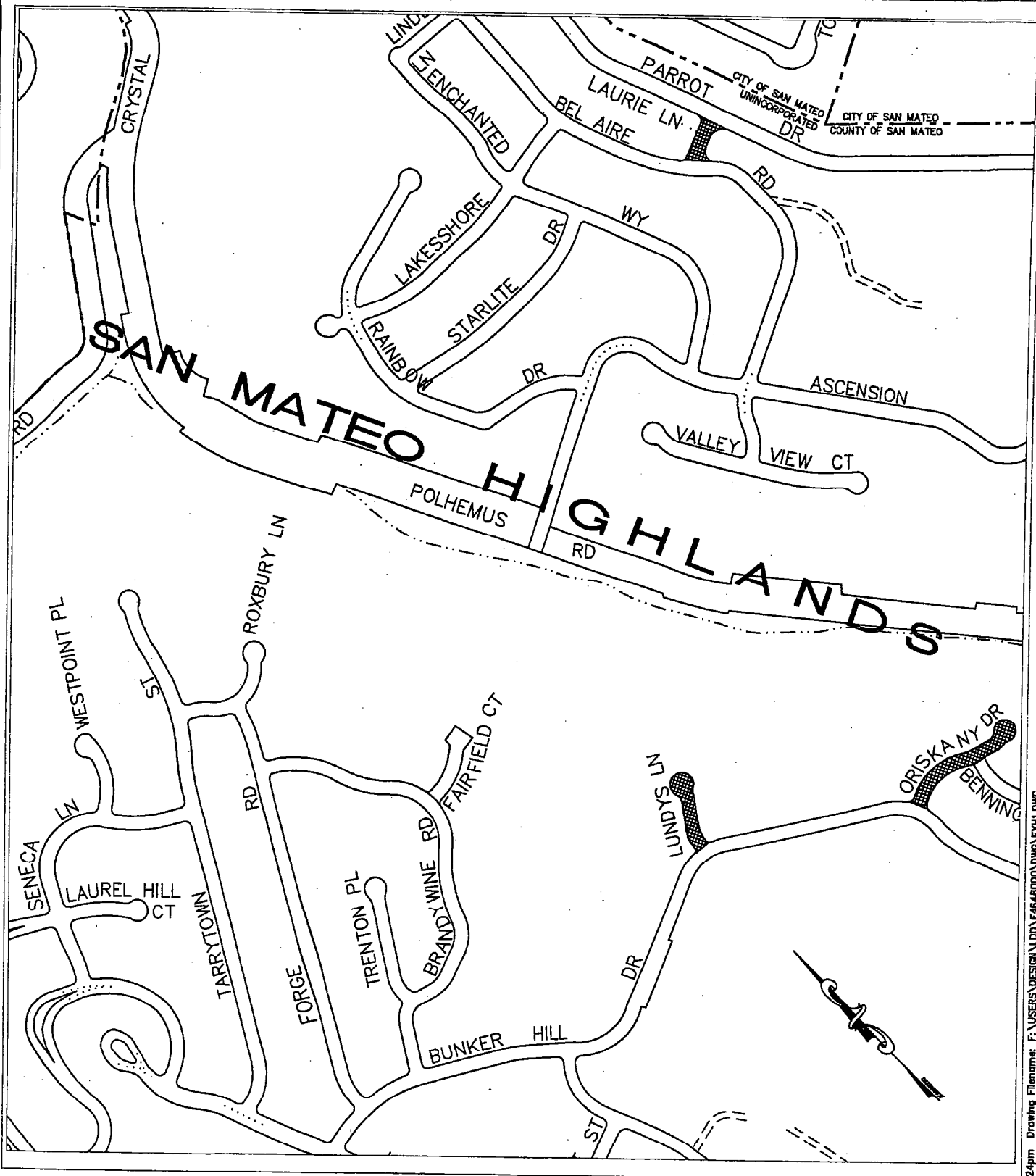

 INDICATES AREAS TO BE SLURRY SEALED

10Dec01 1:24pm Drawing Filename: F:\USERS\DESIGN\LDL\F4648000\DWG\EXH1.DWG



DESIGNED BY: GT  
 CHECKED BY: AMS  
 DRAWN BY: GT

BAYSIDE SLURRY SEAL  
 ROAD IMPROVEMENTS PROJECT  
**PROJECT LOCATION 2 (1/2)**

SCALE: NONE  
 DATE: 12/10/2001  
 FILE NO: **S/4648**

NEIL R. CULLEN, DIRECTOR OF PUBLIC WORKS  
 SAN MATEO COUNTY

555 COUNTY CENTER, 5TH FLOOR  
 REDWOOD CITY, CALIFORNIA 94063-1665

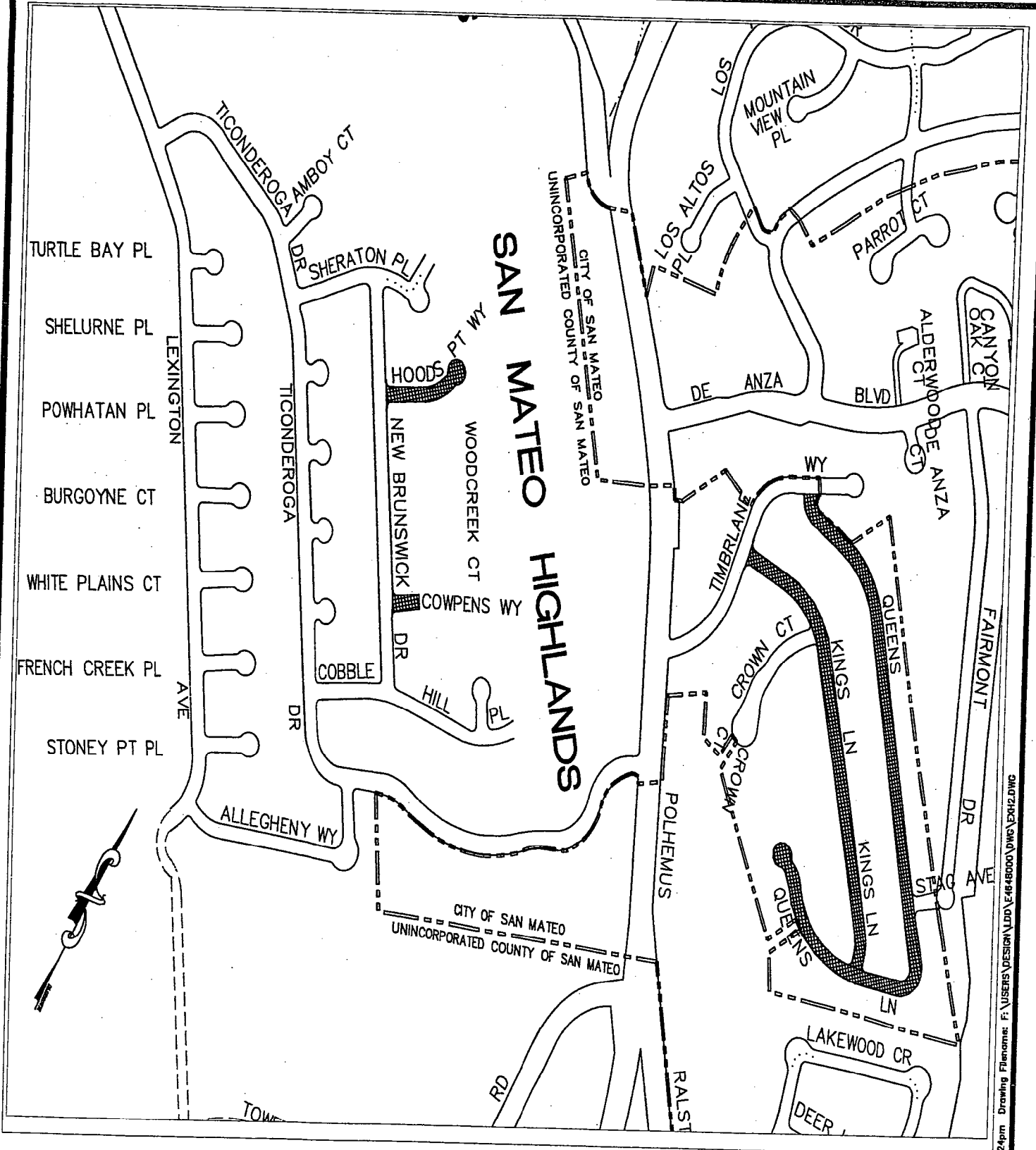

 INDICATES AREAS TO BE SLURRY SEALED



DESIGNED BY: GT  
 CHECKED BY: AMS  
 DRAWN BY: GT

BAYSIDE SLURRY SEAL  
 ROAD IMPROVEMENTS PROJECT  
**PROJECT LOCATION 2 (2/2)**

SCALE: NONE  
 DATE: 12/10/2001  
 FILE NO: **S/4648**

NEIL R. CULLEN, DIRECTOR OF PUBLIC WORKS  
 SAN MATEO COUNTY

555 COUNTY CENTER, 5TH FLOOR  
 REDWOOD CITY, CALIFORNIA 94063-1665

100-mcd1 1:24pm Drawing Filename: F:\USERS\DESIGN\DD\4648\DD\DWG\EXH2.DWG

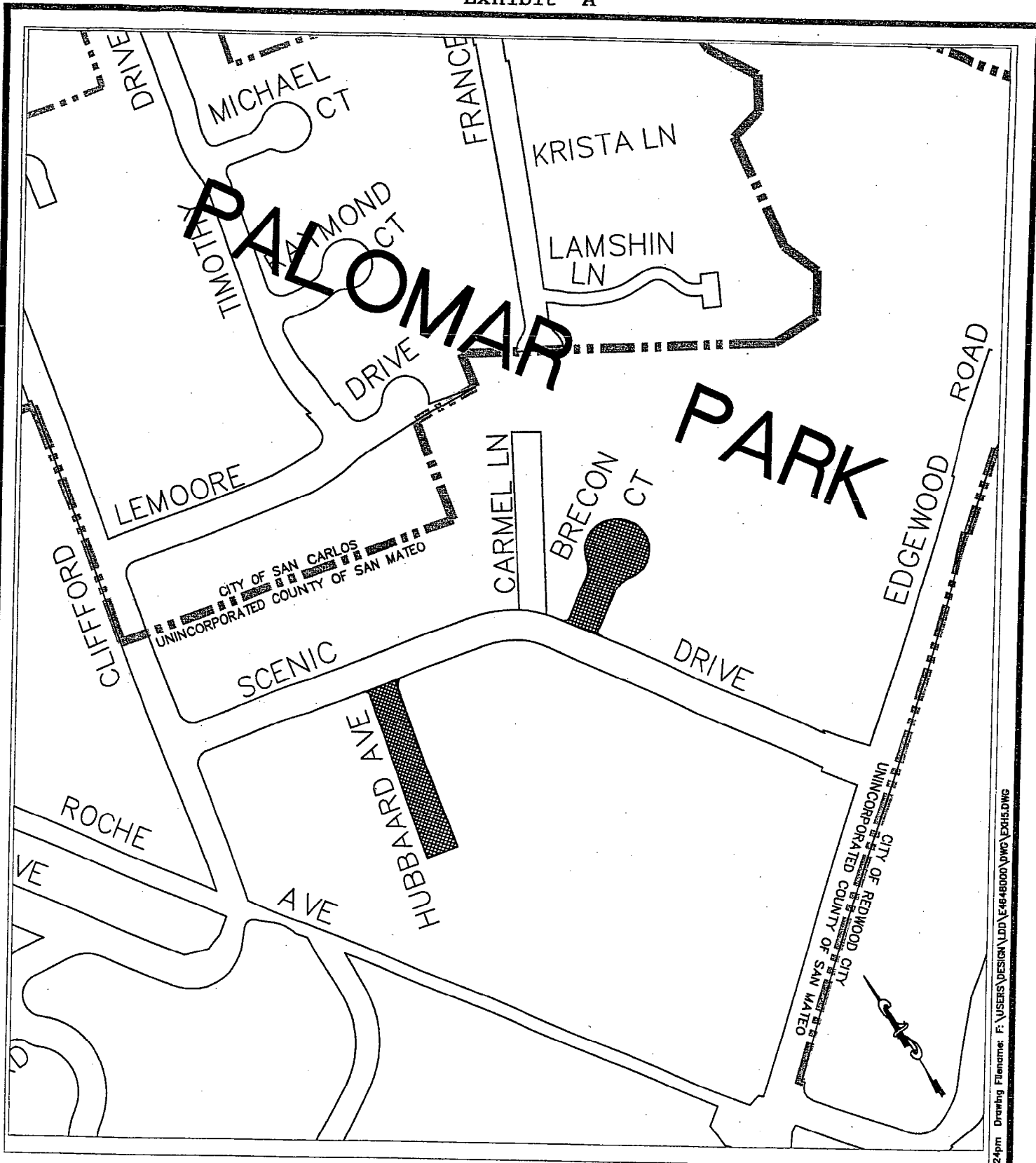

 INDICATES AREAS TO BE SLURRY SEALED

100dec01 1:24pm Drawing Filename: F:\USERS\DESIGN\LDD\14848000\DWG\EXH3.DWG

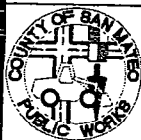

DESIGNED BY: GT  
 CHECKED BY: AMS  
 DRAWN BY: GT

BAYSIDE SLURRY SEAL  
 ROAD IMPROVEMENTS PROJECT  
**PROJECT LOCATION 3 (1/1)**

SCALE: NONE  
 DATE: 12/10/2001  
 FILE NO: **S/4648**

NEIL R. CULLEN, DIRECTOR OF PUBLIC WORKS  
 SAN MATEO COUNTY

555 COUNTY CENTER, 5TH FLOOR  
 REDWOOD CITY, CALIFORNIA 94063-1665

Exhibit "A"

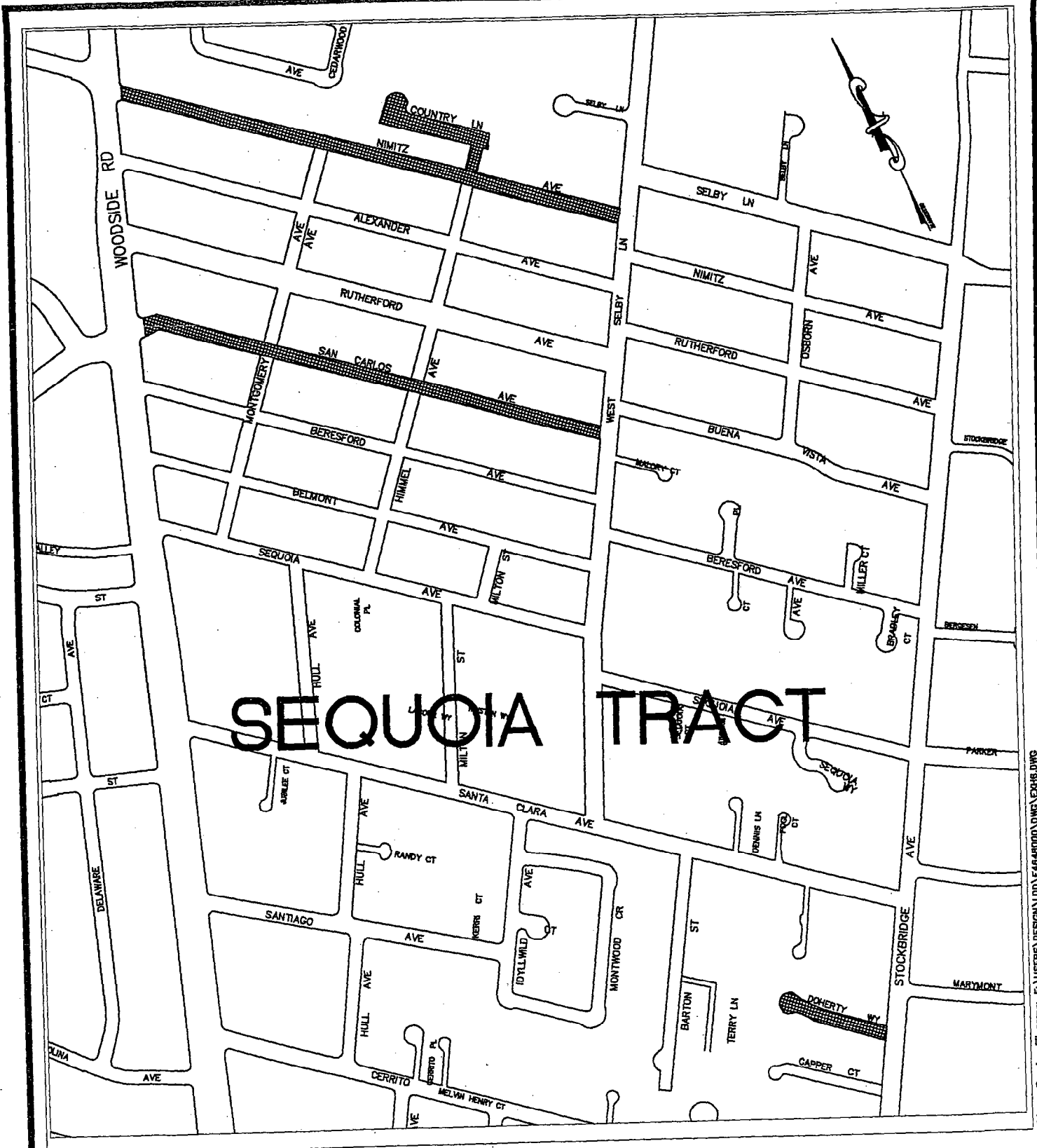

 INDICATES AREAS TO BE SLURRY SEALED

10Dec01 1:24pm Drawing Filename: F:\USERS\DESIGN\LDJ\4648000\DWG\CD48.DWG



DESIGNED BY: GT  
 CHECKED BY: AMS  
 DRAWN BY: GT

BAYSIDE SLURRY SEAL  
 ROAD IMPROVEMENTS PROJECT  
 PROJECT LOCATION 4 (1/1)

SCALE: NONE  
 DATE: 12/10/2001  
 FILE NO: S/4648

NEIL R. CULLEN, DIRECTOR OF PUBLIC WORKS  
 SAN MATEO COUNTY

555 COUNTY CENTER, 5TH FLOOR  
 REDWOOD CITY, CALIFORNIA 94063-1665

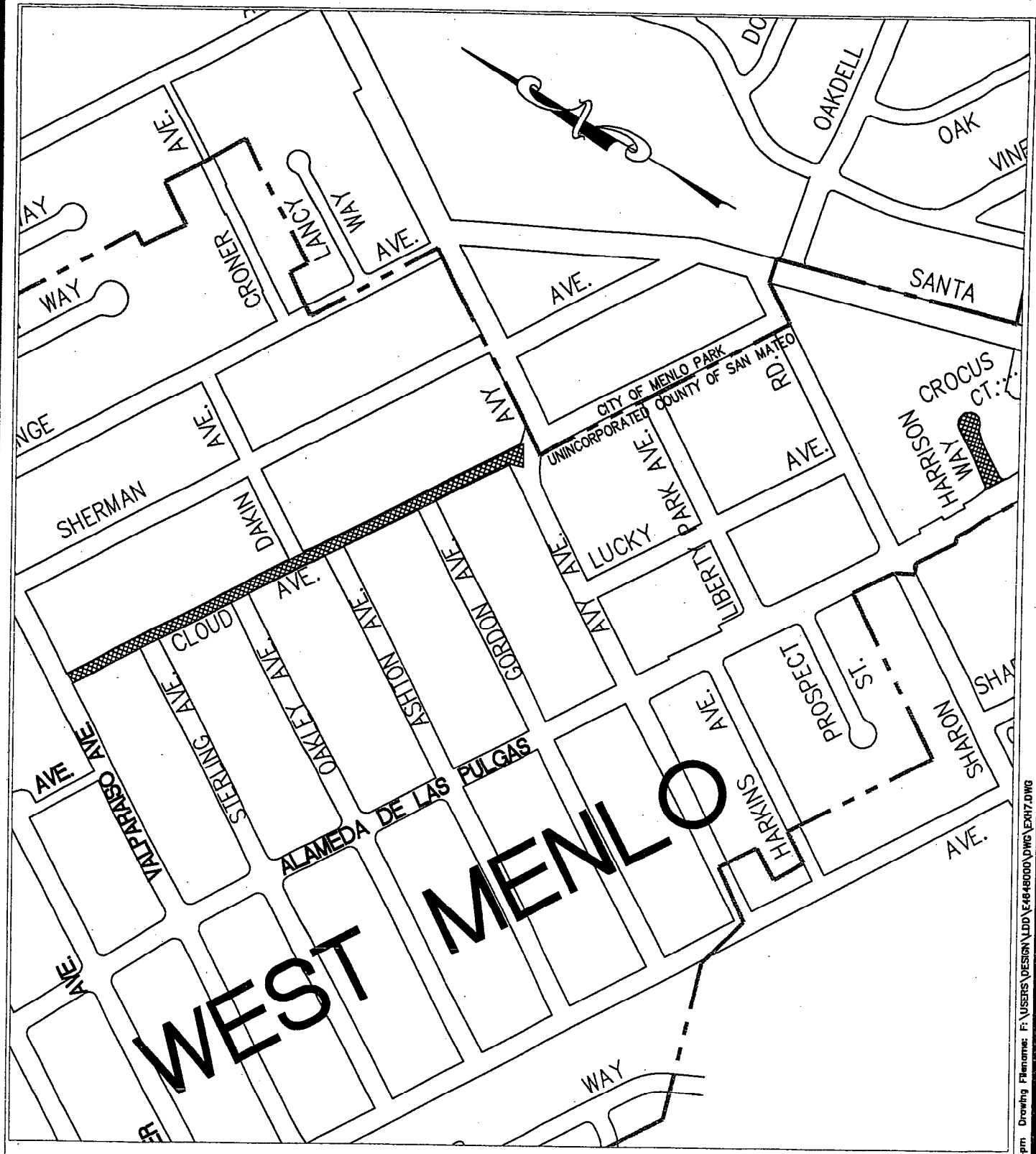

 INDICATES AREAS TO BE SLURRY SEALED

10Dec01 1:24pm Drawing Filename: F:\USERS\DESIGN\LD\14848000\DWG\EXH7.DWG



DESIGNED BY: GT  
 CHECKED BY: AMS  
 DRAWN BY: GT

BAYSIDE SLURRY SEAL  
 ROAD IMPROVEMENTS PROJECT  
**PROJECT LOCATION 5 (1/1)**

SCALE: NONE  
 DATE: 12/10/2001  
 FILE NO: **S/4648**

NEIL R. CULLEN, DIRECTOR OF PUBLIC WORKS  
 SAN MATEO COUNTY

555 COUNTY CENTER, 5TH FLOOR  
 REDWOOD CITY, CALIFORNIA 94063-1665