

LEGEND:

- - - - - CITY/COUNTY BOUNDARY
- ▨ STREET TO BE RESURFACED



DESIGNED BY: MC
 CHECKED BY: AMS
 DRAWN BY: MC

RESURFACING OF HAVEN AVENUE
 IN BELLE HAVEN AREA
LOCATION MAP

SCALE: NONE
 DATE: 02/14/2002
 FILE NO: S/4650

NEIL R. CULLEN, DIRECTOR OF PUBLIC WORKS
 SAN MATEO COUNTY

555 COUNTY CENTER, 5TH FLOOR
 REDWOOD CITY, CALIFORNIA 94063-1665

FILENAME: FAUSERS\DESIGN\LDD\E465000.DWG\LOCATION MAP-HAVEN.DWG

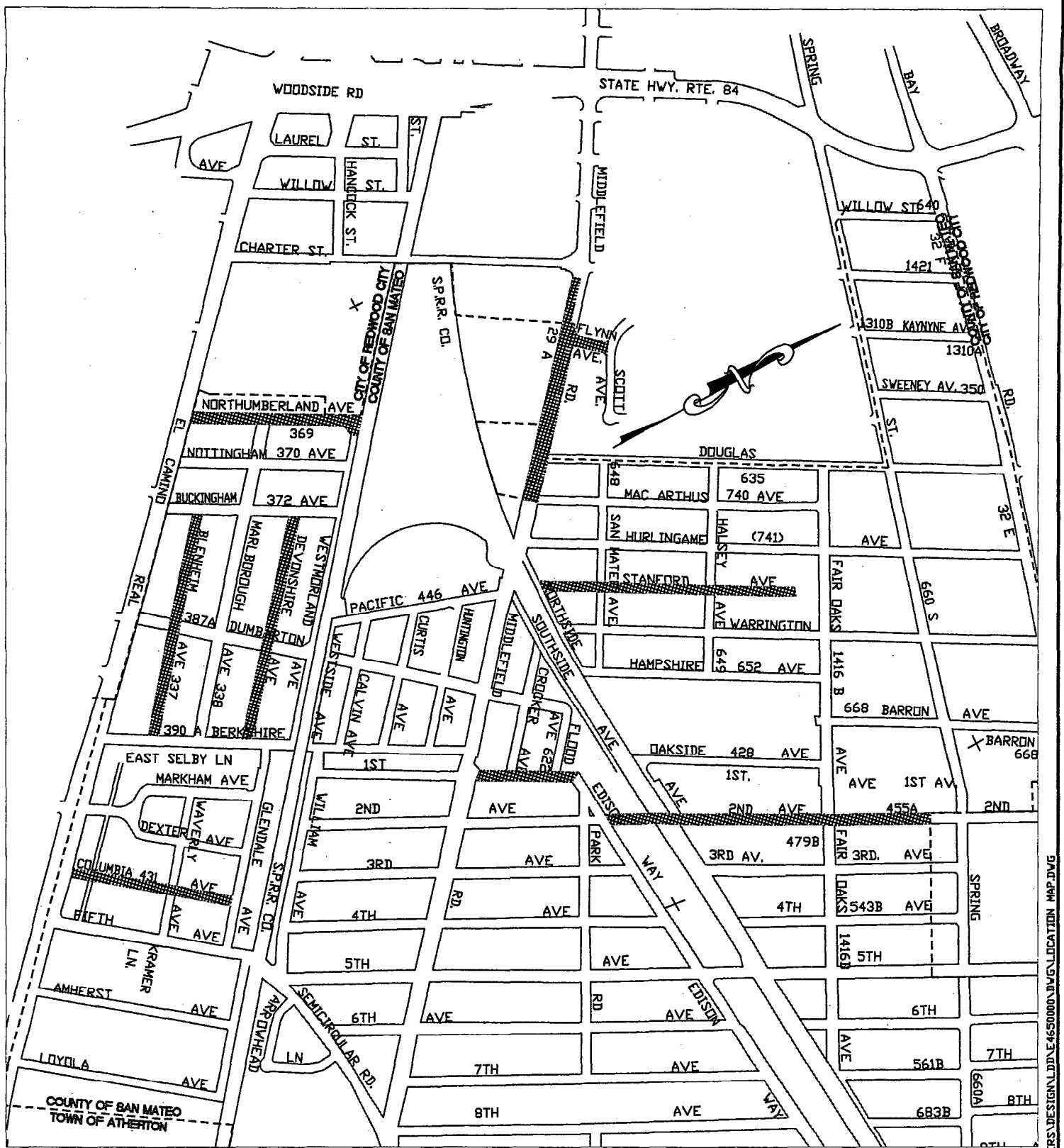

LEGEND:

- CITY/COUNTY BOUNDARY
- ▨ STREETS TO BE RESURFACED



DESIGNED BY: MC
 CHECKED BY: AMS
 DRAWN BY: MC

**RESURFACING OF VARIOUS ROADS
 IN DUMBARTON AND NORTH FAIR OAKS AREAS**

LOCATION MAP

SCALE: NONE
 DATE: 05/14/2002
 FILE NO: S/4650

NEIL R. CULLEN, DIRECTOR OF PUBLIC WORKS
 SAN MATEO COUNTY

555 COUNTY CENTER, 5TH FLOOR
 REDWOOD CITY, CALIFORNIA 94063-1665

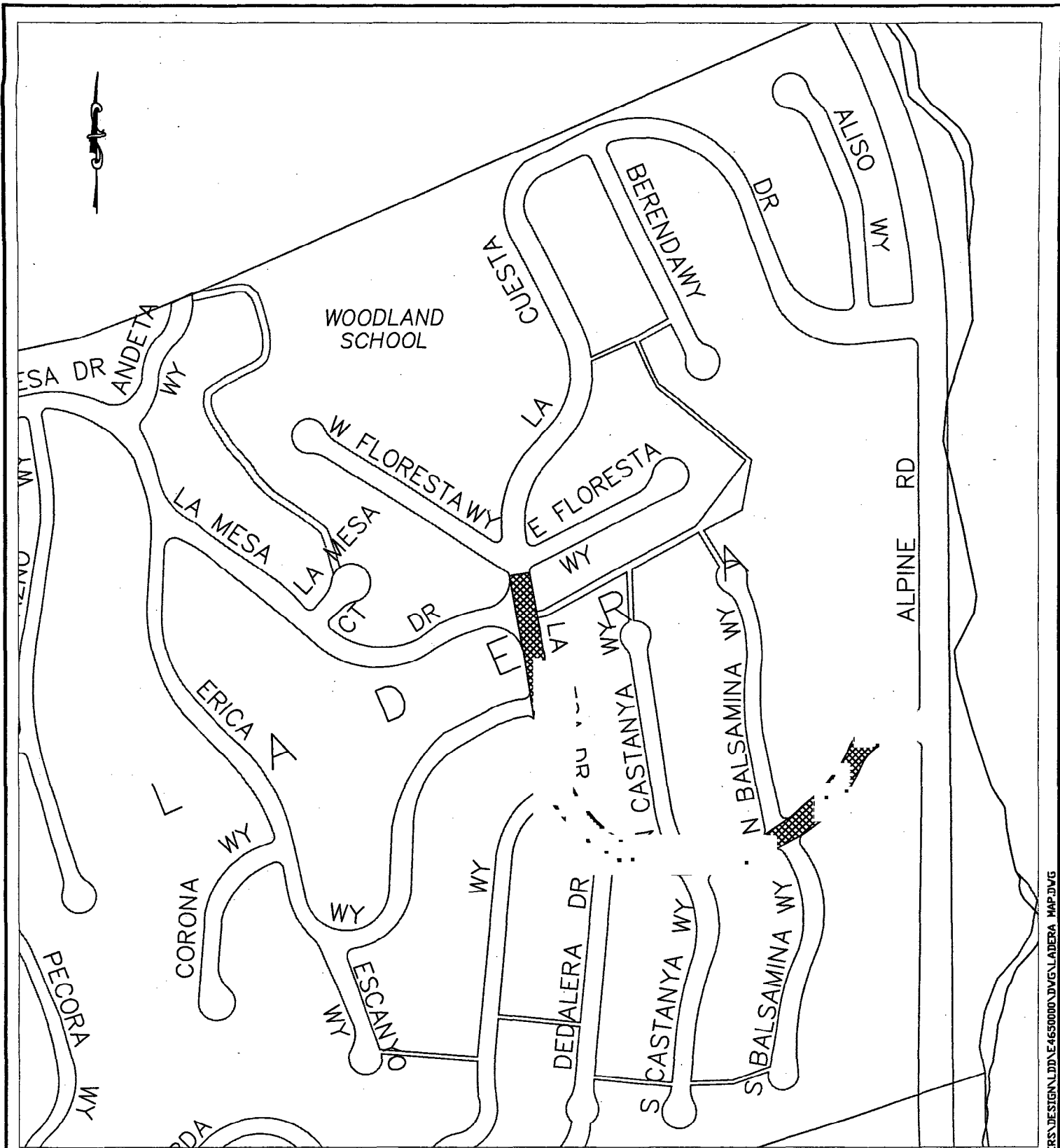

LEGEND:

- CITY/COUNTY BOUNDARY
- STREETS TO BE RESURFACED



DESIGNED BY: MC
 CHECKED BY: AMS
 DRAWN BY: MC

RESURFACING OF LA MESA DRIVE
 IN LADERA AREA
LOCATION MAP

SCALE: NONE
 DATE: 03/22/2002
 FILE NO: **S/4650**

NEIL R. CULLEN, DIRECTOR OF PUBLIC WORKS
 SAN MATEO COUNTY

555 COUNTY CENTER, 5TH FLOOR
 REDWOOD CITY, CALIFORNIA 94063-1665