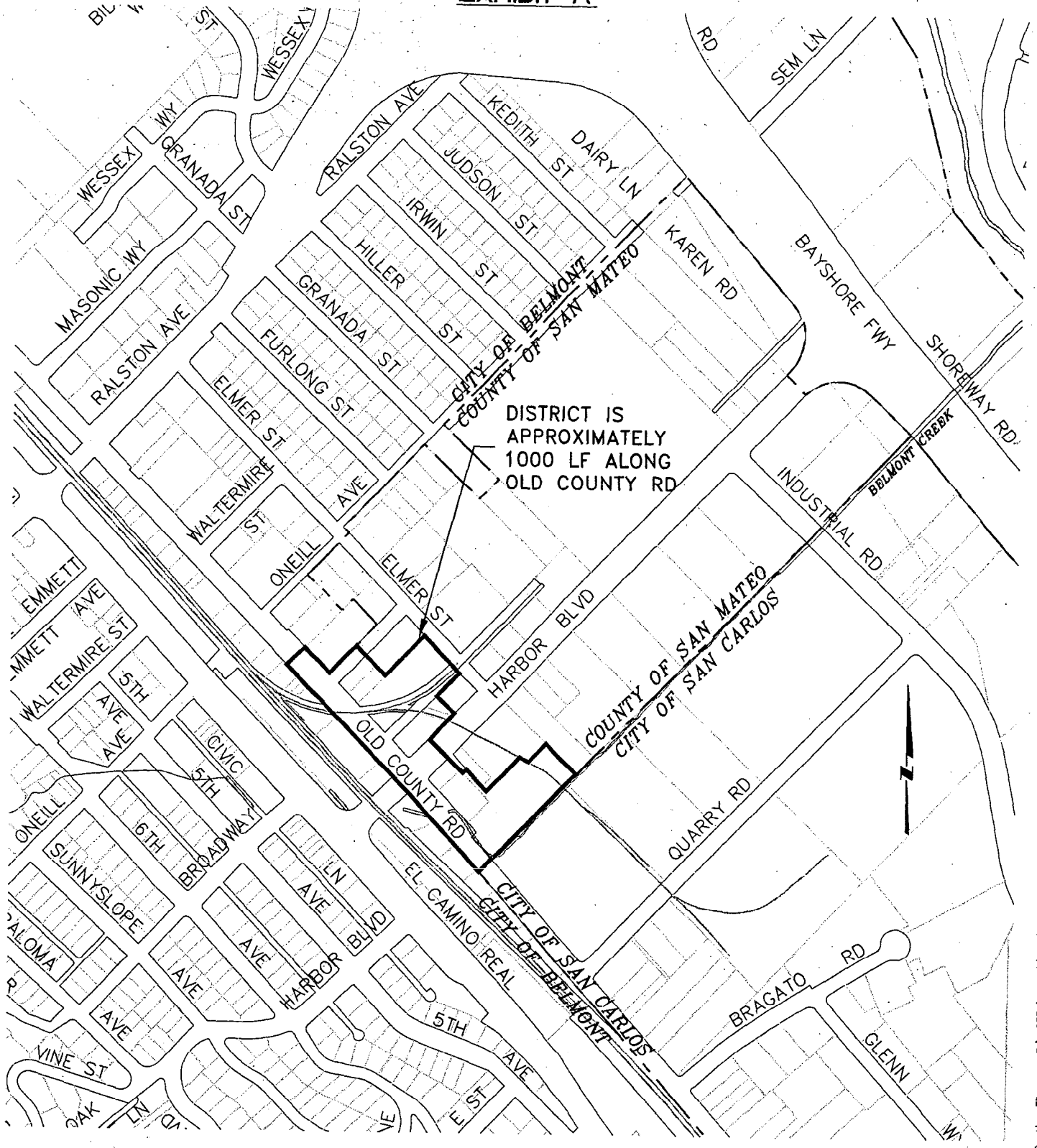

**EXHIBIT "A"**



DISTRICT IS APPROXIMATELY 1000 LF ALONG OLD COUNTY RD

PROPOSED DISTRICT BOUNDARY  
 CITY AND COUNTY LIMIT



DESIGNED BY: JY  
 CHECKED BY: KEM  
 DRAWN BY: JY

**PROPOSED UNDERGROUND UTILITY DISTRICT  
OLD COUNTY ROAD - BELMONT AREA**

SCALE: 1"=500'  
 DATE: 5/04  
 FILE NO: NONE

NEIL R. CULLEN, DIRECTOR OF PUBLIC WORKS  
SAN MATEO COUNTY

555 COUNTY CENTER, 5TH FLOOR  
REDWOOD CITY, CALIFORNIA 94063-1665

## EXHIBIT "B"

### PROPOSED UNDERGROUND UTILITY DISTRICT (VIC. OLD COUNTY ROAD/HARBOR BLVD)

Beginning at the intersection of the southwesterly line of Old County Road (66 feet in width) and the southwesterly prolongation of the southeasterly line of Parcel 3, as said Road and Parcel are shown in Volume 48 of Parcel Maps at Page 91, filed in San Mateo County Recorders Office, said point also being a point in the City Limits of Belmont as established by Resolution on April 14, 1930, said point also being an angle point in the City Limits of San Carlos as established by Resolution No. 1997-106 passed and adopted on August 25, 1997; Thence from said Point of Beginning northwesterly along said southwesterly line and City Limits of Belmont 1,035 feet more or less to an angle point in said city limits; Thence northeasterly along said City Limits and the City Limits of Belmont as established by Incorporation on October 25, 1926, 90 feet more or less to an angle point in the City Limits of Belmont as established by Ordinance No. 65 passed and adopted on March 26, 1945; and a point in the northeasterly line of said Old County Road; Thence southeasterly along said City Limits and northeasterly line 126 feet more or less; Thence leaving said northeasterly line and continuing along said City Limits in a northeasterly direction 141 feet more or less to the intersection with the northwesterly prolongation of the southwesterly line of the parcel of land described in the Deed recorded in Volume 4378 Official Records of San Mateo County Page 423 (55025V), Thence southeasterly 150 feet more or less along said prolongation and southwesterly line to the southerly corner of said parcel; Thence northeasterly along the southeasterly line of said parcel 204 feet more or less to a point in the southwesterly line of Elmer Street; as shown on Volume 29 of Parcel Maps at Page 4, filed in San Mateo County Recorder's Office; Thence southeasterly along said southwesterly line 184 feet more or less to the northerly corner of Lot 13, Block 1 as said Lot and Block are shown on the map entitled "Port of San Francisco, San Mateo County, California" filed in Volume 16 of Maps at Pages 26, 27, and 28, San Mateo County Recorder's Office, said point also being the northerly corner of the parcel of land described in the Deed recorded in Volume 6156 at Page 457 San Mateo County Recorders Office, Thence southwesterly along the northwesterly line of said parcel 117.43 feet more or less to the westerly corner thereof; Thence southeasterly along the southwesterly line of said parcel 90 feet more or less to a point in the northwesterly line of Harbor Blvd. 100 feet in width shown on said map (16 Maps 26) as 80 feet in width; Thence southwesterly along said line 132.57 feet more or less to the southwesterly line of Lot 4, Block 1 as shown on said map; Thence leaving said northwesterly line of Harbor Blvd., southeasterly in a direct line crossing said Blvd 100 feet more or less to a point in the southeasterly line of said Harbor Blvd. said point also being the northerly corner of the parcel of land described in the deed recorded in San Mateo County's Recorder's File No. 92009738, said point also lying in the southwesterly line of 20 foot wide Alley as shown on said map; Thence southeasterly along said

line 75.15 feet more or less, to a point in the northwesterly boundary of said Parcel 3 (48 PM 91); Thence along the boundaries of said Parcel 3 the following courses and distances: North  $43^{\circ} 01'$  East 20.05 feet; Thence South  $42^{\circ} 57' 20''$  East 109.80 feet; Thence North  $43^{\circ} 01'$  East 173.36 feet; Thence South  $62^{\circ} 51' 10''$  East 36.35; Thence North  $43^{\circ} 01'$  East 94.43 feet; Thence South  $46^{\circ} 59'$  East 160.42 feet to the easterly corner of said Parcel 3 and a point in the aforementioned City Limits of San Carlos (Res. #1997-106); Thence southwesterly along said City limits and along the southeasterly line of said Parcel and its southwesterly prolongation South  $43^{\circ} 01'$  West 511 feet more or less to the Point of Beginning.

Containing 7.10 acres more or less.

# EXHIBIT "B"

## PROPOSED UNDERGROUND UTILITY DISTRICT VICINITY OLD COUNTY ROAD/HARBOR BLVD.

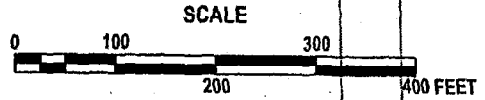

- LEGEND:**
- - - - - EXISTING CITY LIMITS
  - PROPOSED DISTRICT

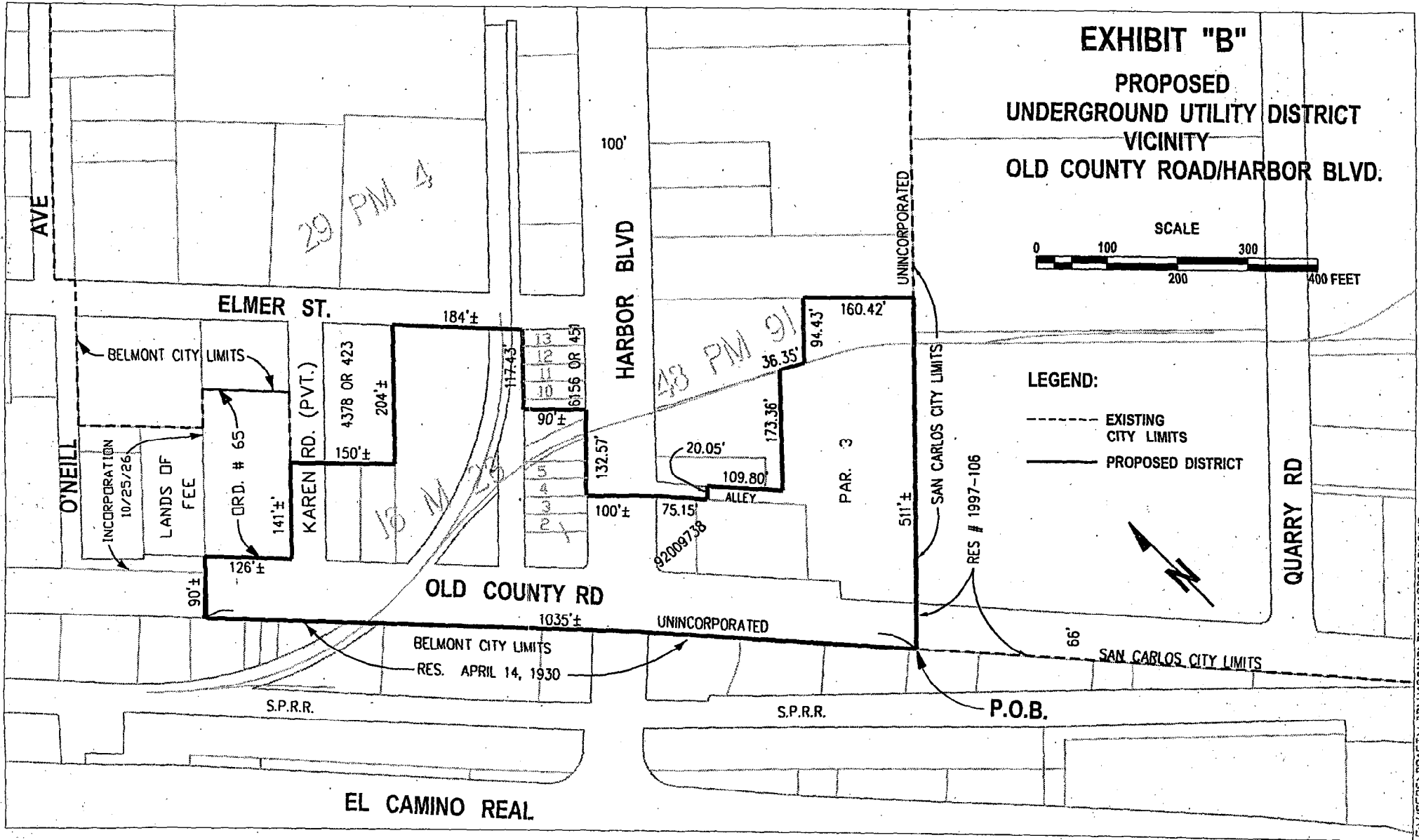

F:\USERS\DRAF\1\LD\HARB\IND\DV\HARBOR\DM.DWG