

EXHIBIT "A"

**PROPOSED ANNEXATION OF THE LANDS OF BABEKIAN
TO THE OAK KNOLL SEWER MAINTENANCE DISTRICT**

9 DON COURT – APN 058-040-200

Lot 11, as shown on the map entitled "TRACT NO. 549 PINECREST MANOR, San Mateo County, Calif." filed in the Office of the Recorder of the County of San Mateo State of California, on May 23, 1946 in Book 25 of Maps, at Page 55, more particularly described as follows:

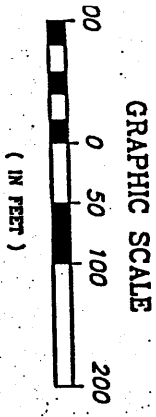
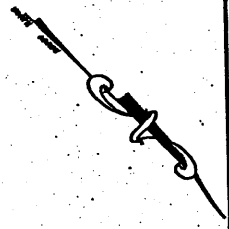

Beginning at the most northerly corner of said Lot 11, said point also being an angle point in the Oak Knoll Sewer Maintenance District boundary as established by Resolution No. 47739 on February 4, 1986; Thence from said Point of Beginning, southwesterly along said district boundaries and along the northwesterly line of said Lot, 215.21 feet more or less to a point in the northeasterly line of Don Court as shown on said map; Thence southeasterly along said northeasterly line, South 44° 47' 44" East 57.77 feet; Thence on an arc curve to the right, having a radius of 155 feet, a central angle of 6° 11' 12", an arc length of 16.74 feet to the southerly corner of said Lot 11; Thence leaving said northeasterly line and said district boundaries North 50° 12' 02" East 216.84 feet along the southeasterly line of said Lot to the easterly corner thereof; Thence North 44° 44' 31" West 92 feet to the Point of Beginning.

Containing 17,923 sq. ft. more or less. = .41 acres more or less.



GRAPHIC SCALE

LEGEND

-  PROPOSED ANNEXATION TO OAK KNOLL SEWER
-  EXISTING OAK KNOLL SEWER DISTRICT
-  CITY LIMIT LINE

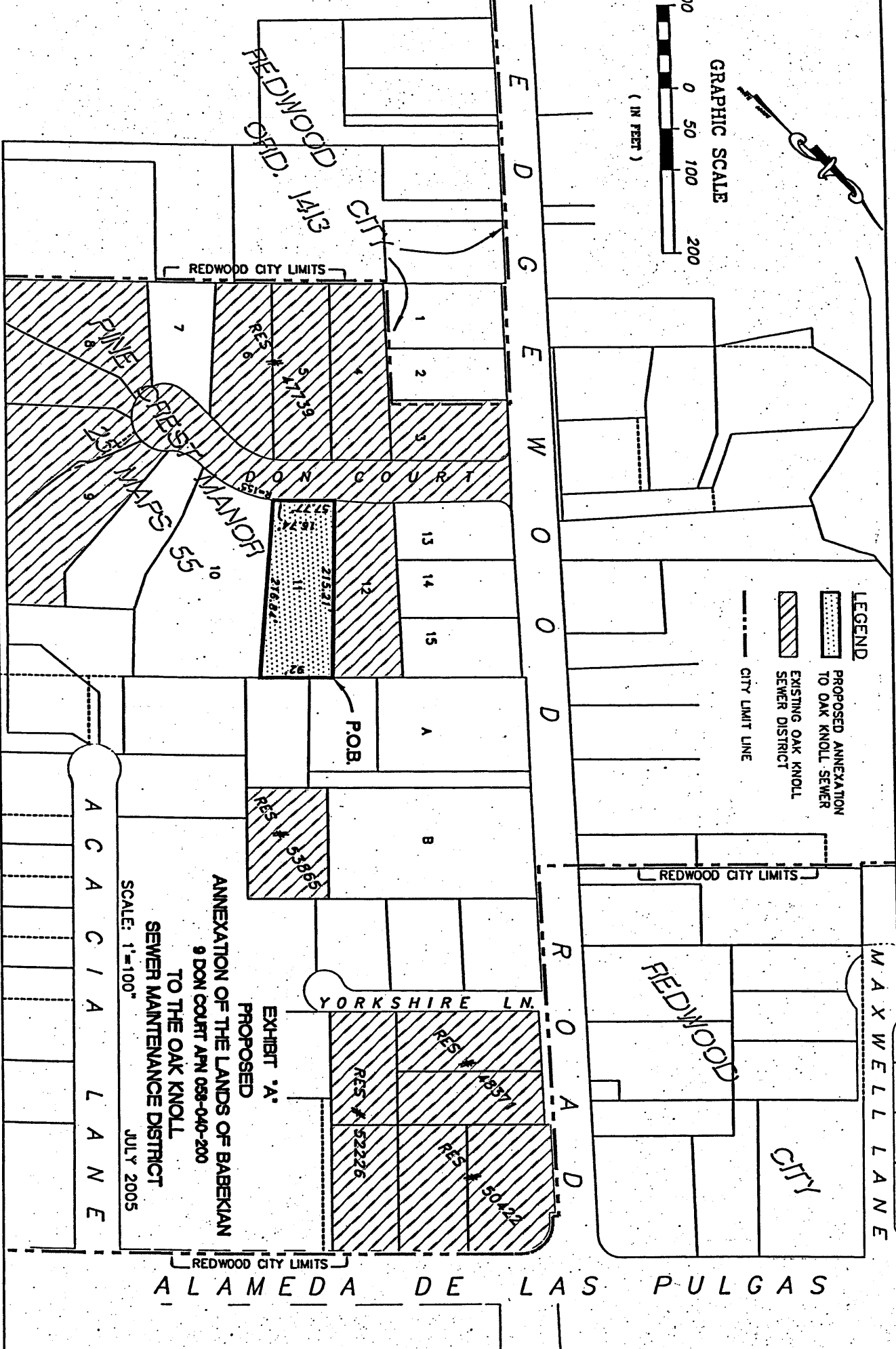

**ANNEXATION OF THE LANDS OF BABEKIAN
TO THE OAK KNOLL
SEWER MAINTENANCE DISTRICT**

9 DON COURT APN 058-040-200

**EXHIBIT 'A'
PROPOSED**

SCALE: 1"=100'
JULY 2005

ORIGINAL

RESOLUTION NO. 14663

**RESOLUTION CONDITIONALLY CONSENTING TO
ANNEXATION OF TERRITORY TO OAK KNOLL SEWER
MAINTENANCE DISTRICT AND APPROVING AND
AUTHORIZING EXECUTION OF ANNEXATION AGREEMENT IN
CONNECTION THEREWITH**

WHEREAS, pursuant to that certain agreement entitled "Agreement Between Oak Knoll Sewer Maintenance District and City of Redwood City for Sewage Treatment and Disposal," dated March 18, 1958 (the "Services Agreement"), by and between the City of Redwood City ("City"), and the Oak Knoll Sewer Maintenance District ("District"), City provides sanitary sewerage transmission and treatment services to District; and

WHEREAS, pursuant to that certain agreement entitled "Agreement - Wastewater Treatment Capacity (Emerald Lake Hills Area)," dated August 19, 1980 (the "Capacity Agreement"), by and between City and the County of San Mateo, sanitary sewerage treatment capacity rights are allocated by City for the benefit of areas within County, including lands within District's boundaries; and

WHEREAS, the District Services Agreement provides that no sewage emanating from territory annexed to District shall be deposited in City's sanitary sewerage system without the prior consent of City evidenced by Resolution of the Council of the City of Redwood City; and

WHEREAS, City is in receipt of a request for consent to annexation to District of the real property hereinafter described (the "Annexing Property") and also designated by the following Assessor's Parcel Number:

APN 058-040-200 (Address: 9 Don Court, Owners: Robert and Silva Babekian); and

WHEREAS, the Annexing Property is located within City's Sphere of Influence as determined by the San Mateo County Local Agency Formation Commission pursuant to Government Code Section 54774; and

WHEREAS, as one of the conditions of consenting to annexation of the Annexing Property to District, City requires that the owners of said Property consent to annexation thereof to City in the event a proposal for such annexation to City may occur; and

WHEREAS, this Council has reviewed said request and is willing to consent to said annexation in accordance with the terms and conditions hereof.

NOW, THEREFORE, BE IT RESOLVED BY THE COUNCIL OF THE CITY OF REDWOOD CITY, AS FOLLOWS:

1. This Council hereby consents to the annexation of the Annexing Property to the Oak Knoll Sewer Maintenance District subject to all terms and conditions of the Services Agreement and to payment of all appropriate sewer connection fees and other charges.

2. This Council hereby determines and declares that, and as a further condition to the consent to annexation herein granted, treatment of sewage emanating from the Annexing Property shall be provided under sanitary

sewerage treatment capacity rights allocated to the County of San Mateo pursuant to the Capacity Agreement.

3. The Annexing Property is all that certain real property situate in the County of San Mateo, State of California, more particularly described in an exhibit attached to Exhibit "A" hereof, (with plat attached to said included exhibit), which Exhibit A is attached hereto and by this reference incorporated herein.

4. This Council hereby determines and declares that, and as a further condition to the consent to annexation to District herein granted, the owner(s) of the Annexing Property shall evidence his/her consent to annexation to City and waiver of protest thereto by executing an agreement substantially in the form of Exhibit A, the form of which agreement is hereby approved, and the City Manager is hereby authorized and directed to execute said agreement, and the City Clerk is hereby directed to attest thereto, for and on behalf of City.

5. The City Clerk is hereby authorized and directed to file for recordation with the Recorder of the County of San Mateo, California, a certified copy of this Resolution together with the fully executed original annexation agreement (in the form of Exhibit "A") entered into with the owners of the Annexing Property.

* * *