

Attachment A – Proposed Parking Restrictions and Public Input Summary

Item #1: Authorizing the establishment of a two-hour time limited parking zone in Harbor/Industrial, City of Belmont area

Address	Area	Description	Objections	Support
645 Harbor Blvd.	Harbor/Industrial	Page 2	1	0

Item #2: Authorizing the establishment of a disabled parking zone in El Granada, Half Moon Bay area

Address	Area	Description	Objections	Support
427 El Granada Blvd.	El Granada	Page 3	0	0

Item #3: Authorizing the amendment of a designated no parking zone in El Granada, Half Moon Bay area

Address	Area	Description	Objections	Support
427 El Granada Blvd.	El Granada	Page 3	0	0

Item #4: Correcting the location of one of the five time limited parking zones established by Resolution No. 70022 (Northside Avenue in North Fair Oaks, Redwood City area).

Address	Area	Description	Objections	Support
2737 Northside Ave.	North Fair Oaks	Page 4	0	0

Item #5: Correcting the location of a no parking zone in North Fair Oaks, Redwood City area established by Resolution No. 70023;

Address	Area	Description	Objections	Support
2737 Northside Ave.	North Fair Oaks	Page 4	0	0

Item #6: Correcting the location of a no parking zone in North Fair Oaks, Redwood City area established by Resolution No. 70024; and

Address	Area	Description	Objections	Support
2737 Northside Ave.	North Fair Oaks	Page 4	0	0

Item #7: Correcting the location of a designated time limited parking zone in North Fair Oaks, Redwood City Area, established by Resolution No.67697

Address	Area	Description	Objections	Support
2844 Middlefield Rd.	North Fair Oaks	Page 5	0	0

Descriptions of Proposed Traffic Control Devices by Location:

Item	Location
Item # 1	645 Harbor Blvd.

Establish a new 47-foot long two-hour time limited parking zone and other traffic markings at 645 Harbor Blvd. in Harbor/Industrial, Belmont area

Discussion: The Director of Public Works at the City of Belmont requests that we change the parking layout in front of the auto repair business at 645 Harbor Blvd. Residents complained to him that vehicles parked in the stalls in front of the business extend into the travel way. The business owner is concerned that parallel parking will reduce the number of parking spaces and thereby impact his business opportunities. Staff reviewed the site and recommends the following changes:

- The parking stalls can be restriped to minimize encroachment into the travel way, as shown in Figure A below.
- Existing parking stall markings will be removed by grinding
- The number of parking stalls will be reduced from 6 stalls to 4 stalls because of new angle of the stalls. Parallel parking will only allow 2 stalls.
- The stall width should be reduced from 8.5 feet to 8 feet to allow for the maximum number of stalls
- Staff recommends installing “Compact Only” signs in front of the stalls
- Paint an edge line to show the back of the stalls
- Paint a crosshatched area to guide drivers making a right turn from Old County Rd. to Harbor Blvd.

Figure A. Location Map with Proposed Traffic Markings Layout

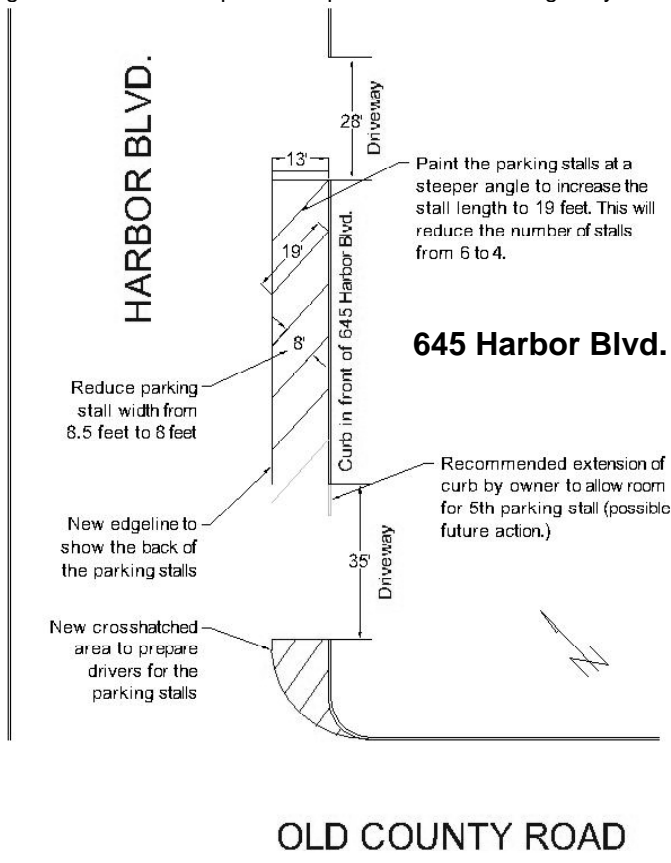

Descriptions of Proposed Traffic Control Devices by Location:

Item	Location
Items# 2, and 3	427 El Granada Blvd.

Establish a new disabled parking zone and the reduction of a no parking zone at 427 El Granada Blvd. in El Granada, Half Moon Bay area

Discussion: The resident who lives at 427 El Granada Blvd. requests a disabled parking zone on El Granada Blvd. in front of his property because the location is currently designated as a no parking zone. Staff reviewed the site with the Coastside Fire Marshall and has received concurrence to permit a disabled parking zone at this specific location because of the following:

- The requestor has a Department of Motor Vehicles Disabled Parking placard
- There is no other suitable off-street parking available to the requestor
- The width of the one-way road in front of the requestor's home is sufficient for a fire engine to pass, so we may remove part of the existing no parking zone to accommodate the requestor.

Figure B. Location Map with Proposed Disabled Parking Zone

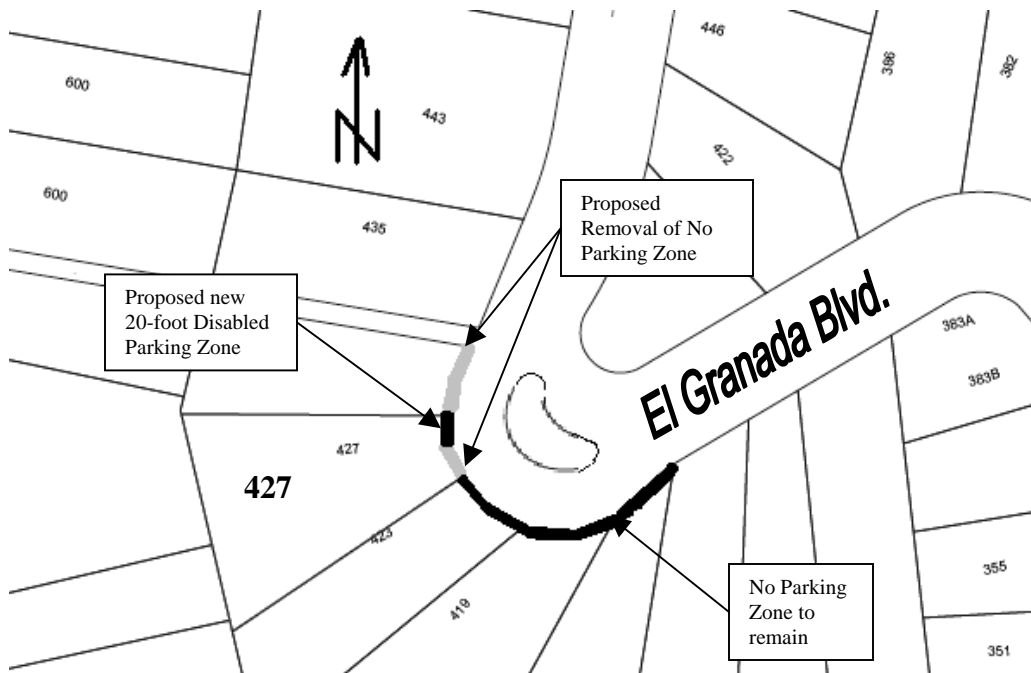

Descriptions of Proposed Traffic Control Devices by Location:

Item **Location**
Items # 4, 5, and 6 2737 Northside Ave.

The correction of Resolutions 70022, 70023, and 70024 adopted on March 31, 2009:
Establish a new no parking zone, amend a no parking zone, and establish a new twenty-minute time limited parking zone at 2737 Northside Avenue in North Fair Oaks, Redwood City area

Discussion: The business located at 2737 Northside Avenue requested changes to the existing No Parking Zone across the street from the property.

The new parking arrangement is proposed as follows (from west to east):

- 115 feet long new 20-minute time limited parking across from the business
- 66 feet long new No Parking Zone
- The entire south side of Northside Ave. between Warrington Ave. and Hampshire Ave. will be no parking (remove the 135-foot 20-minute time limited parking zone that was approved with Resolution 070022.)

Staff reviewed the site and recommends the changes because of the following:

- The new 20-minute Time Limited Parking zone will suit the business's needs
- The new No Parking Zone will aid the truck drivers in their turning movement between Warrington Ave. and Northside Ave.
- The new parking zone arrangement will not negatively impact neighborhood parking

Please note: These items appeared on the March 31, 2009 Board of Supervisors meeting. Staff inadvertently labeled the wrong streets in the board report. This is only a correction.

Figure C. Location Map with Proposed Changes to Time Limited Parking and No Parking Zones

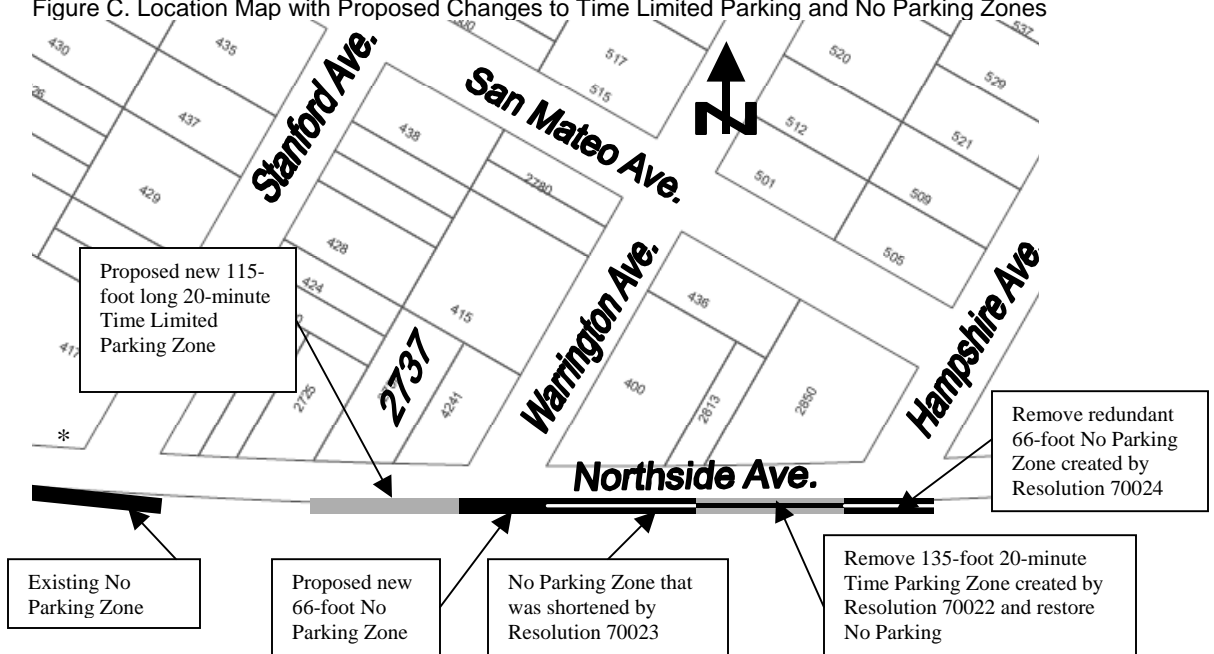

*The north side of Northside Ave. is currently designated as no parking for the extents of Figure C and there will be no changes to that restriction.

Descriptions of Proposed Traffic Control Devices by Location:

Item	Location
Item # 7	2844 Middlefield Road

Resolution 67697 adopted on December 6, 2005 generally designating two-hour time limited parking zones in public right-of-ways includes the following designation:

On both sides of MIDDLEFIELD ROAD commencing at the DUMBARTON SPUR RAILROAD CROSSING and extending southeasterly to the intersection of EIGHTH AVENUE, a distance of 7,200 feet, more or less, between the hours of 9:00 a.m. to 4:00 p.m. excepting therefrom where other parking restrictions are implemented by Resolution of the Board of Supervisors.

Staff recommends making the following exception:

Change 30 feet of angled two-hour time limited parking zone to one loading zone at 2844 Middlefield Rd. in North Fair Oaks, Redwood City area

Discussion: The business owner at 2844 Middlefield Rd. requests that two angled 2-hour time limited parking stalls to be changed to one loading zone to better serve the business.

Staff reviewed the site and recommends the change because of the following:

- The loading zone would allow the business owner to load and unload their goods near the entrance
- The new loading zone will not negatively impact neighborhood parking

Figure D. Location Map with Proposed Change in Parking Designation

