

Attachment A – Map of Proposed Traffic Control Device Locations and Public Input Summary

Authorizing an enforceable prima facie speed limit of 40 miles per hour for the County-maintained portion of Hillside Boulevard, City of South San Francisco area

February 9, 2010

Figure 1. Location of Proposed Speed Limit Change

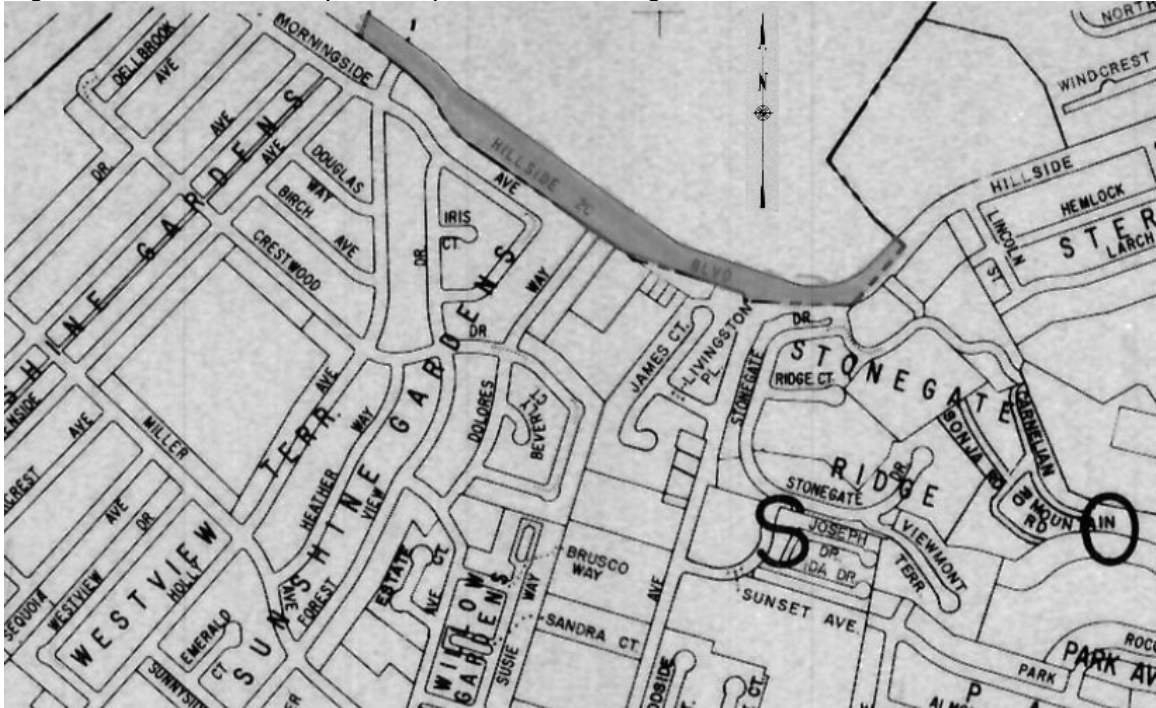

Agency Comments:

Town of Colma City Engineer, 11/20/09, Objects to increase in speed limit because concerned for public safety, received requests to reduce speed limit, request that we perform further studies

Petitions:

Petition #1: 11/7/09, 40 people signed, Strongly opposed to the speed limit increase, there have been accidents, there are schools nearby, concerned for pedestrians and students at nearby schools

Petition #2: 11/17/09, 30 people signed, Stop speed limit increase on Hillside between Lincoln and Evergreen, reduce speed limit between Lincoln and Lawndale to 25 mph, "rezone Hillside Blvd. to be changed from 'unincorporated' to 'residential' between Lincoln and Lawndale"

Petition #3 11/18/09, 38 people signed, Stop speed limit increase on Hillside between Lincoln and Evergreen, reduce speed limit between Lincoln and Lawndale to 25 mph, “rezone Hillside Blvd. to be changed from ‘unincorporated’ to ‘residential’ between Lincoln and Lawndale” (additional sheets of Petition #2 by separate cover)

Table 1. Public Input Summary

Date	Favor	Oppose	Comments (via email, letter, or phone call)
10/30/09		X	Concerned for pedestrian safety, safety of drivers entering and exiting Sunshine Gardens, should increase enforcement
10/30/09		X	Feels it is dangerous to turn onto Holly from Hillside
11/1/09		X	Speeds will creep up above new speed limit, dangerous to turn onto/out of side streets
11/2/09		X	Should raise speed limit to 55 mph
11/2/09		X	Should lower speed limit, accidents along Hillside
11/4/09		X	Should be zoned residential, accidents, concerned for students, many schools in area
11/10/09		X	Higher speeds will be unsafe, accidents, difficult to get to his home
11/16/09		X	More enforcement, accidents, churches, schools in area, difficult turning
11/19/09		X	City of S San Francisco is trying to calm traffic on nearby streets, please take accidents and other local factors into consideration
Total		9	